

SCREENED MAX™ MODULE

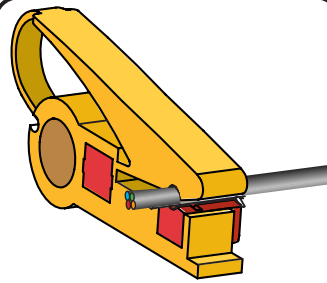

1 Using a Siemon ALLPREP™ tool or equivalent remove approximately 38 mm. (1.5 in.) of sheathing.

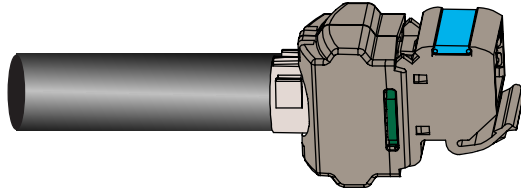
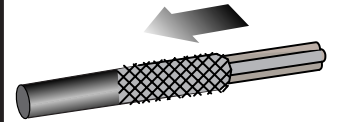

2 Pull back braiding or foil and cut off plastic barrier if present.

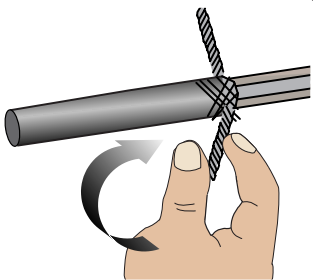

3 Form excess braid or foil into 2 pigtails.

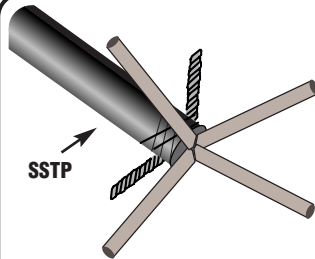

4 Separate shielded pairs into an "X" shape.
NOTE: For ScTP Cable, proceed to step 7.

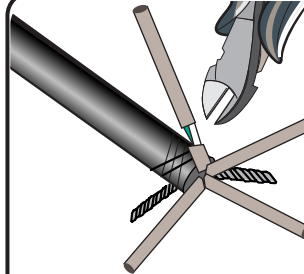

5 Carefully, put a starter cut into the foil as close to the center of the "X" as possible.

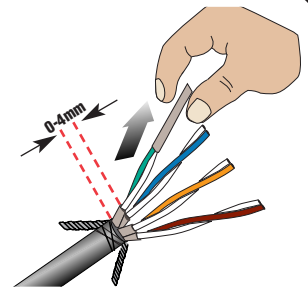

6 Peel the remaining foil off all four pairs. At this time all pairs should be exposed.

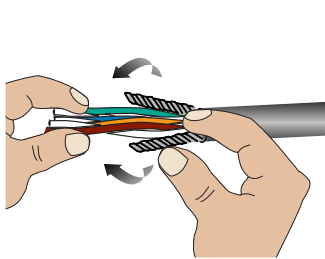

7 Form the pairs and pigtails into a single piece.

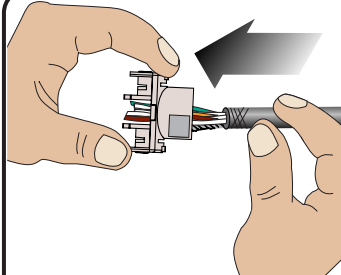

8 Insert cable and pigtails through the center opening of the termination cap until it bottoms out.

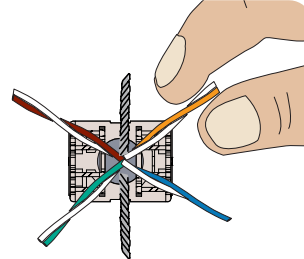

9 Arrange pairs in an "X" being sure to follow wire map on termination cap.

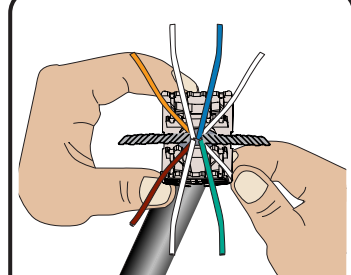

10 Push wires one at a time into the wire guides.

SCREENED MAX™ MODULE

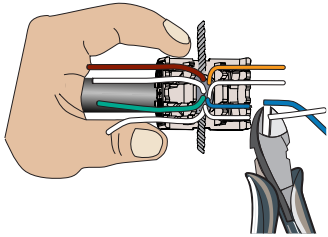

11 After all wires are in place trim off excess wire as close to the cap as possible.

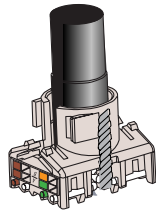

12 Wrap the pigtails over the sides of the cap.

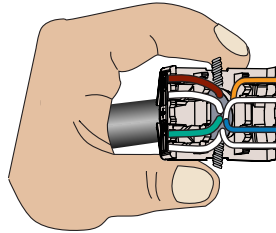

13 Inspect cap for correct wiring and lacing of conductors. Be sure foil or braids and all conductors are fully seated into slots as shown.

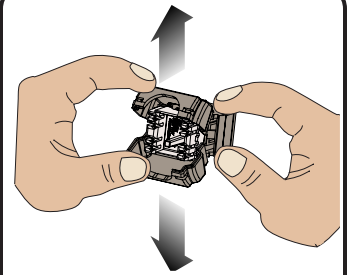

14 Prepare the jack for insertion by opening the shield case.

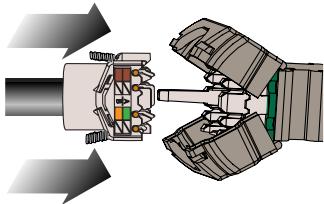

15 Insert the termination cap with the shield guide post aligning with the channel in the termination cap cuff.

Push forward until seated tightly together.

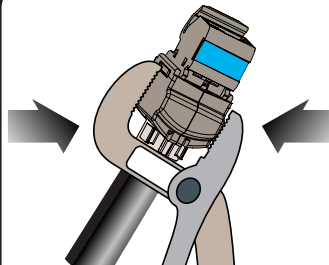

16 Using pliers, squeeze the shield case together.

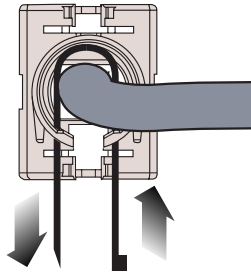

17 Insert tie wrap into termination cap using slots in cuff. Tie wrap should form a "U" shape inside the cap.

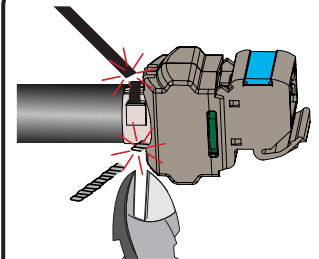

18 Tighten tie wrap. Trim excess tie wrap and braid pigtail.

To assist safe installations, comply with the following:

- A. Use caution when installing or modifying telecommunications circuits.
- B. Never touch uninsulated wire terminals unless the circuit has been disconnected.
- C. Never install this device in a wet location.
- D. Never install wiring during a lightning storm.



The Siemon Company Australia

Sydney, Australia
Tel: (61) 2 9452 2666

The Siemon Company Canada

Markham, Ontario
Tel: (1) 905 940 9223

The Siemon Company China

Beijing, P.R. China
Tel: (86) 10 6858 7358

The Siemon Company Ltd. Europe & Middle East

Woking, England
Tel: (44) (0) 1483 480040

The Siemon Company Latin America

Coral Gables, Florida
Tel: (1) 305 446 9150

Latin America Sales Manufacturer's Representatives

Castroville, Texas USA
Tel: (1) 830 538 6375

The Siemon Company Southeast Asia

Singapore
Tel: (65) 285 7579

The Siemon Company USA

Watertown, Connecticut
Tel: (1) 860 274 2523