

Ergonomic Flat Screen Supports



The increased demand for visualization in many control consoles and control rooms means that the number of monitors at workstations in particular is also constantly increasing. Along with the right desk, appropriate and ergonomic monitor connections and arrangements are therefore also important elements of the setup. The Knürr brand has been representative of ergonomics at the monitor workstation for over 25 years.

Ergonomically positioned monitors prevent health-hazardous bad posture. The right viewing angle to the monitor ensures an ideal view and back-friendly sitting position at the same time. Studies, tests and surveys, etc., show that workstations that are set up the right ergonomic way reduce the number of sick days.



Knürr's universally applicable supports are not only suitable for flat screens – they are also ideal for ergonomically positioning workstation lamps and speaker systems, or communication equipment on control station desks.



Source: DLR







DAC20087

Type A



DAC20192

Type B



DAC20193

Type C



DAC20191

Type H



TFT-Halter T45

Flat Screen Supports

- Flat screen holders for fixing with VESA adapters, 75/100 mm
- with cable management

Supply schedule

- 1 flat screen support
- Type E, F and G with pre-mounted height adjustment plate
- Fixing material

How supplied

Flat-packed kit

Type A-G

- For mounting on Knürr double functional rails
- Swivel arm depth adjustment or gas pressure spring arms for height adjustment
- Fast swap-out with rail adapters
- Any horizontal positioning on double functional rails

Material Type A-G

- Swivel arm – die-cast aluminium
- Adapter plates – sheet steel
- Gas pressure spring arm covers – plastic

Finish Type A-G

Metal parts – powder-coated, RAL 9006, White aluminum, smooth
Gas pressure spring arm housing – type B/C: Plastic, light gray

Type H

- With extension arm
- Integrated gas pressure spring
- With quick connector function

Flat Screen Support T45

- For mounting on Knürr double functional rails
- Only 45 mm mounting depth
- Tilttable of -30° to +30°

Finish / Material

Gas pressure spring arm housing: Die-cast aluminum, silver
Extension arm: Aluminum, silver

Model	Height adjustment plate	Load-bearing capacity	Order no.	UP
Type A, short		12 kg	01.316.206.1	1 unit
Type B, tiltable		3-8 kg	01.316.207.1	1 unit
Type C, tilt/swivel		3-8 kg	01.316.208.1	1 unit
Type D, short		12 kg	01.316.210.9	1 unit
Type E, medium	•	10 kg	01.316.211.9	1 unit
Type F, long	•	10 kg	01.316.212.9	1 unit
Type G, double joint	•	8 kg	01.316.213.1	1 unit
Type H, Gas pressure spring arm with extension arm		8 - 15 kg	01.316.258.9	1 unit
Flat Screen Support T45		10 kg	01.316.228.9	1 unit



CIC20031

Type D



CIC20032

Type E



CIC20033

Type F



CIC20034

Type G



Support Pole for TFT Swivel Arm

- Slender design
- Enables easy adapter height setting in any position
- For single or double connection parts (see page 6)
- Freely combinable – one or two row setup
- Up to 32 kg load capacity

Workstation mounting

- With desk clamp or threaded connection, both with plastic underlay to protect the worktop
- For worktop thickness 15 mm – 40 mm

Supply schedule

- 1 support pole adapter with base plate
- 1 clamp or threaded connection
- Fixing material

How supplied

Flat-packed kit

Dimensions

- Diameter 30 mm
- Height 400 mm or 700 mm

Material

- Aluminum tube
- Base – die-cast aluminum

Finish

Metal parts – powder-coated, RAL 9006, white aluminum

Note

The worktop must be drilled through for mounting with threaded connection



DAC20164

H	Type of fixing	Order no.	UP
400	Desk clamp	01.316.231.9	1 Stk
700	Desk clamp	01.316.232.9	1 Stk
400	Threaded connection	01.316.233.9	1 Stk
700	Threaded connection	01.316.234.9	1 Stk

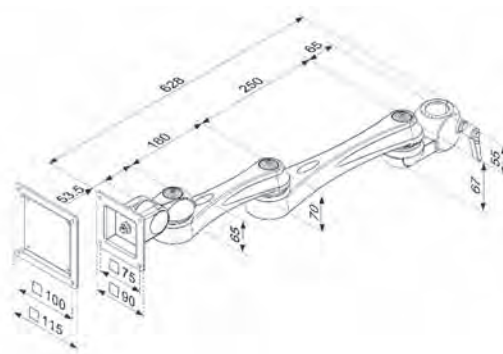
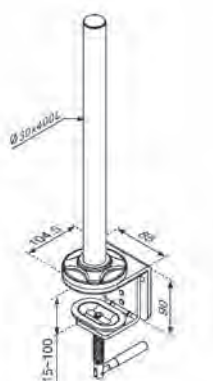

Swivel arm components

Components can be combined with one another.
Maximum configuration – see drawing.

Supply schedule

1 component
Mounting material

How supplied

Flat packed

Model	Order no.	UP
TFT mounting	01.316.219.9	1 unit
VESA 100 Adapter Plate	01.316.253.1	1 unit
TFT Swivel Arm, L 180	01.316.217.9	1 unit
TFT Swivel Arm, L 250	01.316.218.9	1 unit

Dimensions in mm: W= Width
H = Height
D = Depth
h = Installation height
d = Useful depth
L = Length

HU = Standard height unit, 1 HU = 44.45 mm
19"= 482.6 mm, (ideal for 19" components in acc. with DIN 41494)
UP = Unit of packaging
kg = Weight

Conversion: 1 mm = 0.03937 inch
1 kg = 2.2046 pound
Replace "x" with the number of your color choice



KON20086



ERG00042

Connection Parts for TFT Tube Supports

- For TFT tube support with 30 mm diameter
- Single or double adapter
- Enables easy adapter height setting in any position

Supply schedule
1 connection part – single or doubled

How supplied
Flat-packed kit

Dimensions
- Connector part axis-center distance;
single 65 mm
- Connector part axis-center distance;
double 130 mm

Material
Die-cast aluminum

Finish
Metal parts – powder-coated, RAL 9006,
white aluminum

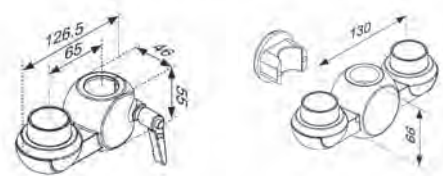

Model	Order no.	UP
Connection part, single	01.316.224.9	1 unit
Connection part, double	01.316.227.9	1 unit



DAC20159



DAC20160

Twin Adapter

- Rail system for two flat screens
- Rotatable on 6 axes
- Tool-less quick change system
- Integrated adjustable gas pressure spring for easy height adjustment
- Practical cable routing elements
- With leveling base, desk clamp or threaded connection
- Up to 15 kg load capacity

Supply schedule
- 1 twin adapter
- 1 base plate, desk clamp or
threaded desk connection
- Mounting material

How supplied
Flat-packed kit

Dimensions
- VESA adaption 75/100 mm
- Total width 752 mm
- Monitor adjusting range – horizontal,
370 - 650 mm
- Height 390 mm
- Stabilizer arm adjusting angle 65°

Material
- Sheet steel leveling base 8 mm
- Aluminum extrusion cross rail
- VESA adapter, base adapter –
die-cast aluminum
- Stabilizer housing – die-cast aluminum and
plastic

Finish
Metal parts – powder-coated, RAL 9006,
white aluminum

Model	Order no.	UP
Twin adapter with leveling base	01.316.235.9	1 unit
Twin adapter with desk clamp	01.316.236.9	1 unit
Twin adapter with threaded desk connection	01.316.237.9	1 unit

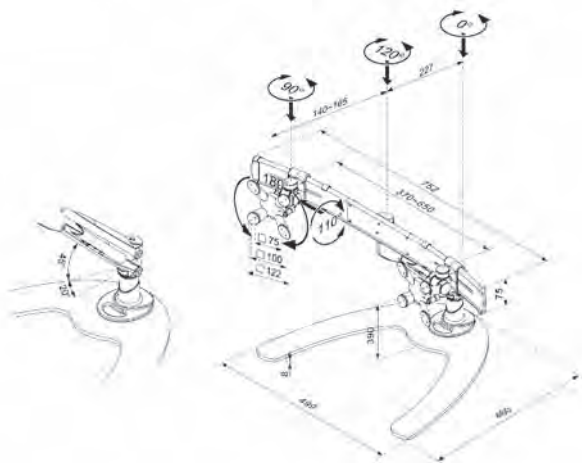

Dimensions in mm: W = Width
H = Height
D = Depth
h = Installation height
d = Useful depth
L = Length

HU = Standard height
unit, 1 HU = 44.45 mm
19" = 482.6 mm,
(ideal for 19" components
in acc. with DIN 41494)
UP = Unit of packaging
kg = Weight

Conversion:

1 mm = 0.03937 inch
1 kg = 2.2046 pound

Replace 'x' with the number of your
color choice

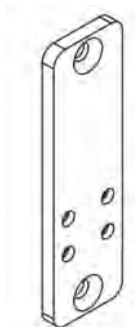

DAC20159

Extrusion adapter for TFT arms

For mounting type D to G + T45 flat screen holders instead of the hang-on bracket

Supply schedule

- 1 mounting panel
- 1 allen key, 4 mm
- 1 allen key, 5 mm
- Mounting material

How supplied

Flat-packed kit

Finish

Powder-coated,
RAL 9006, white aluminum

W	H	D	Order no.	UP
30	105	5	01.316.214.9	1 unit



DAC20028

Functional Rails with Workstation Superstructure

- Rail system with desk clamp
- For Knürr Elicon® worktops 30 mm, or Knürr Dacobas® control console corner worktops 20 mm
- For flat screens with adapter (see page 4)
- Can be upgraded at any time
- Rails can be mounted on two heights
- For TFT adapter and organizational accessories
- Up to 48 kg load capacity

Dimensions

- Various widths
- Height 323 mm
- Tube diameter 40 mm

Material

- Aluminum extrusion double functional rail
- Die-cast aluminum desk clamps
- Steel tube

Supply schedule

- 1 double functional rail
- 1 stay tube set
- Mounting material

Finish

Metal parts – powder-coated, RAL 9006, white aluminum

How supplied

Flat-packed kit

Note

TFT-Adapter are not included in the supply schedule

W	H	Desk system	Model	Bestell-Nr.	VE
660	323	Knürr Elicon®		04.303.090.9	1 unit
1060	323	Knürr Elicon®		04.303.091.9	1 unit
1460	323	Knürr Elicon®		04.303.092.9	1 unit
1400	323	Knürr Dacobas®	90°-trapezoid corner	01.315.096.9	1 unit



ERG00022

Functional Rails with Workstation Superstructure electric height-adjustable

- Simply convenient – monitor level height adjustment at the touch of a button
- Upgradeable on workstations with space for monitor level
- For flat screens with adapter (see page 4)
- Straight rails (ideal for several operators) or circular segments for ergonomic cockpit shape (perfect for one operator)
- With cable chain for safe cable routing
- Stylish switch unit with hinge function for mounting under the front worktop edge
- Optional horizontal cable comb (see page 12)
- Rails can be mounted at different heights for ergonomically optimum adjustment to conditions
- Up to 80 kg load capacity

How supplied

Flat-packed kit

Dimensions

- Setting range (height setting) 200 mm
- One-row column height 650 mm
- Rails – straight or with 5000 mm radius

Material

- Aluminum extrusion double functional rail
- Plastic cable chain

Finish

- Metal parts – powder-coated, RAL 9006, white aluminum
- Cable chain – black

Supply schedule

- One or two row double functional rails – straight or circular segment
- 1 electric-adjustable vertical column set with up/down switch
- Cable chain
- Mounting material

Note

TFT-Adapter are not included in the supply schedule

W	Version	Number of monitors	Order no.	UP
1550	Straight, one-row	4	01.316.240.9	1 unit
1950	Straight, one-row	5	01.316.241.9	1 unit
1950	Circular segment, one-row	4	01.316.242.9	1 unit
2350	Circular segment, one-row	5	01.316.243.9	1 unit



DAC20162

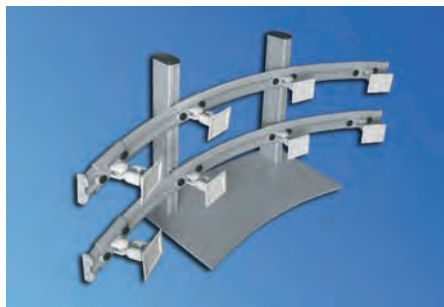

DAC20173

TFT Adapter for 8 Monitors

- Rail system with base plate for stable standing
- Rails in two rows for four monitors each
- Straight rails (ideal for several operators) or circular segments for ergonomic cockpit shape (perfect for one operator)
- Can be upgraded at any time
- Up to 96 kg load capacity

Supply schedule

- 1 base plate
- 2 vertical extrusions
- 2 double functional rails – straight or circular segments
- 8 TFT Adapters, type A (see page 4)
- Mounting material

How supplied

partially assembled

Dimensions

- Rail width 1800 mm
- Rails – straight or with 2000 mm radius
- Total height 750 mm
- Base plate W x D x T 800 x 450 x 10 mm

Material

- Aluminum extrusion double functional rails and vertical extrusions
- Sheet steel base plate 10 mm
- Plastic caps

Finish

Metal parts – powder-coated, RAL 9006, white aluminum

Model	Order no.	UP
8-way adapter with straight rails	01.316.247.9	1 unit
8-way adapter with circular segment rails	01.316.248.9	1 unit



CiCon8489

Multi-Functional Extrusions for Knürr Products

- For mounting between the Knürr Products vertical extrusions
- Sturdy and stable Knürr TFT Adapter connection (see pages 4-5)

Note

TFT adapters are not included in the supply schedule, please order separately

How supplied

Flat-packed kit

Material

- Extruded aluminum extrusions
- Sheet steel mounting plates

Finish

Metal parts – powder-coated, RAL 9006, white aluminum

Supply schedule: 2 Functional rails; Mounting material

W	Model	Order no.	UP
596	Knürr DacoMobile®	00.101.008.9	1 unit
763	Knürr DacoMobile®	00.101.009.9	1 unit
450	Knürr EliMobil®	00.306.980.9	1 unit
550	Knürr EliMobil®	00.306.981.9	1 unit
500	Knürr MetraMobil®	00.701.055.9	1 unit
1064	Knürr CiCon®	01.315.078.9	1 unit

Supply schedule: 1 Functional rail; Mounting material

W	Model	Order no.	UP
800	Knürr Elicon®	04.208.200.9	1 unit
1200	Knürr Elicon®	04.208.201.9	1 unit
1600	Knürr Elicon®	04.208.202.9	1 unit
1800	Knürr Elicon®	04.208.203.9	1 unit
2000	Knürr Elicon®	04.208.204.9	1 unit
570	Knürr Dacobas®	01.316.200.9	1 unit
630	Knürr Dacobas®	01.315.070.9	1 unit
800	Knürr Dacobas®	01.316.203.9	1 unit
830	Knürr Dacobas®	01.315.071.9	1 unit
1030	Knürr Dacobas®	01.315.072.9	1 unit
1140	Knürr Dacobas®	01.316.201.9	1 unit
1200	Knürr Dacobas®	01.316.204.9	1 unit
1230	Knürr Dacobas®	01.315.073.9	1 unit
1430	Knürr Dacobas®	01.315.074.9	1 unit
1600	Knürr Dacobas®	01.316.205.9	1 unit
1630	Knürr Dacobas®	01.315.075.9	1 unit
1710	Knürr Dacobas®	01.316.202.9	1 unit
1830	Knürr Dacobas®	01.315.076.9	1 unit
2030	Knürr Dacobas®	01.315.077.9	1 unit



MOB20061

Note
Two identical functional rails are required for mounting flat screen holders!



Wall Mounting Bracket Tiltable

- For big flat screens
813 mm - 1550 mm (32"-61")
- Easy mounting
- More viewing comfort – effortless tilting,
prevents bothersome reflections
- Security lock against unauthorized flat
screen removal
- Up to 79 kg load capacity

Supply schedule

- 1 mounting rail
- 2 mounting brackets
- Mounting material

How supplied

Flat-packed kit

Dimensions

- Tilt angle +15° / -5°
- Wall distance 89 mm

Material

- Aluminum extrusion rail
- Sheet steel mounting bracket
- Plastic caps

Finish

Metal parts – powder-coated, RAL 9006,
white aluminum

W	H	D		Order no.	UP
704	157,5	89	Wall Mounting Bracket, tiltable	01.316.270.0	1 unit
900	157,5	89	Wall Mounting Bracket, tiltable XL	01.316.271.0	1 unit

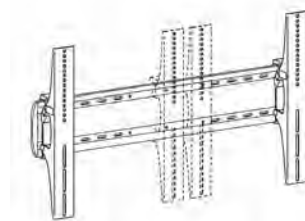
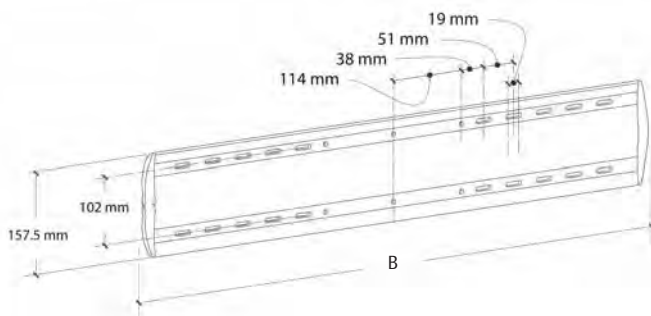

ERG00038

Ceiling Bracket Telescopic

- For big flat screens
940 mm - 1650 mm (37"-65")
- More viewing comfort – effortless tilting,
prevents bothersome reflections
- Up to 80 kg load capacity

Supply schedule

- 1 ceiling bracket
- 1 flat screen holder, tiltable
- Mounting material

How supplied

Flat-packed kit

Dimensions

- Telescopic from 850 mm to 1150 mm
- Tilt angle up to 20°
- Total width 831 mm
- Depth 68 mm

Material

Sheet steel

Finish

Metal parts – powder-coated, black

W	Order no.	UP
831	01.316.238.9	1 unit

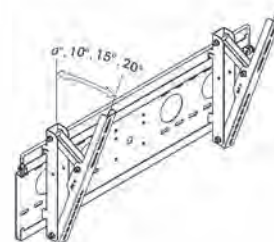
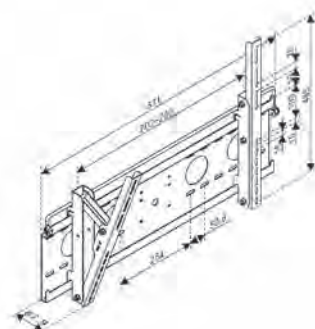

Dimensions in mm: W= Width
H = Height
D = Depth
h = Installation height
d = Useful depth
L = Length

HU = Standard height
unit, 1 HU = 44.45 mm
19"= 482.6 mm,
(ideal for 19" components
in acc. with DIN 41494)
UP = Unit of packaging
kg = Weight

Conversion: 1 mm = 0.03937 inch
1 kg = 2.2046 pound
Replace 'x' with the number of your
color choice



MOB00331

Wiring Duct

- Plastic wiring duct
- Simply stick together
- Flexible
- Temperature-resistant up to +160 °C
- Self-extinguishing in acc. with UL 94 V0

Supply schedule
1 wiring duct

How supplied
Flat-packed kit

Dimensions

- Height 20 mm or 40 mm
- Length 500 mm

Material
PVC

Finish
Light gray or black

H	Color	Mounting material	Order no.	UP
40	Light gray	•	00.101.001.9	1 unit
40	Light gray		01.350.543.9	1 unit
20	Light gray		01.350.542.9	1 unit
40	Black		01.350.545.9	1 unit



ELM00025

Cable Routing Ring

- For tidy and orderly cable management
- Open version, no threading
- Mounting on the T-slots of the vertical extrusions
- Installation position freely selectable

Supply schedule
- 5 cable routing rings
- Mounting material

How supplied
Flat-packed kit

Dimensions
54 x 118 mm

Material
PA 6, GF 10, gray, UL 94-V1

Finish
Gray

Model	Order no.	UP
54x118	1.312.207.9	1 unit



MEC20185

Velcro® Quick-Strip for T- slot Tool less mounting

- Quick and tool less mounting
- for bundling cables
- removable and re-usable
- for tidy and orderly cable management
- for mounting on T-slots at any position

Supply schedule
10 Velcro® strips

How supplied
Flat-packed kit

Material
Polyethylene and Nylon

Finish
Black
F.R.T., UL-94 HB

Order no.	UP
00.218.506.0	1 unit

Dimensions in mm: W= Width
H = Height
D = Depth
h = Installation height
d = Useful depth
L = Length

HU = Standard height
unit, 1 HU = 44.45 mm
19"= 482.6 mm,
(ideal for 19" components
in acc. with DIN 41494)
UP = Unit of packaging
kg = Weight

Conversion:

1 mm = 0.03937 inch
1 kg = 2.2046 pound

Replace 'x' with the number of your
color choice



DAC20175



DAC20176

VESA Adapter Plates

- For adapting VESA 100/200 and VESA 200/200 threaded connections to VESA 75 and VESA 100
- Single adapter for monitors up to 12 kg
- Double adapter for monitors up to 24 kg on 2 Vesa 75/100 holders

Supply schedule

- 1 adapter plate
- Mounting material

How supplied

Flat-packed kit

Material

Sheet steel

Finish

Powder-coated, RAL 9006, white aluminum

W	H	Model	Order no.	UP
220	220	single	01.316.244.9	1 unit
501	250	double	01.316.245.9	1 unit



ERG00040

VESA Fast Change Plate

- Quick, tool-less monitor swap-out via spring balancer
- For adapting VESA 75/100 threaded connections
- With height adjustment holes
- Low installation depth – only 15 mm

Supply schedule

- 1 adapter plate
- Mounting material

How supplied

Flat-packed kit

Dimensions

- Width 130 mm
- Height 170 mm
- Depth 15 mm

Material

Sheet steel

Finish

Powder-coated, RAL 9006, white aluminum

W	H	D	Order no.	UP
130	170	15	01.316.239.9	1 unit



CIC20020

Lamp Adapter for Functional Rail

The Knürr accessory range workstation lamps are delivered as standard with a universal adapter. This adapter is perfect for optimum to the Knürr functional rail.

Supply schedule

- 1 adapter
- Fixing material

How supplied

Flat-packed kit

Material

Sheet steel and aluminum swivel part

Finish

Metal parts – powder-coated, RAL 9006, white aluminum

	Order no.	UP
I	01.316.225.9	1 unit



DAC20170

Perforated Rear Panel

- For rear mounting on the multi-functional rails or flat screen adaption cross extrusions
- As privacy screen or cable protection
- Both vertical and horizontal mounting possible

- Supply schedule**
 - 1 perforated rear panel
 - Mounting material

- How supplied**
Flat-packed kit

Dimensions

- Width 400 mm
- Height 815 mm
- Depth 57 mm

Material

Sheet steel

Finish

Powder-coated, RAL 9006, white aluminum

W	H	D	Order no.	UP
400	815	57	01.316.209.9	1 unit

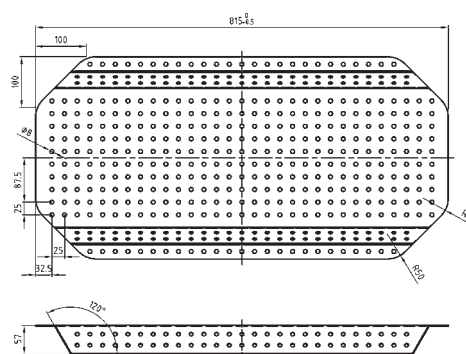

ERG00021

Cable Duct for Electric-Adjustable Multi-Functional Rails

- For rear mounting on the multi-functional rails (cable routing at the front)
- Horizontal cable duct for straight rails and circular segment rails

- Supply schedule**
 - 1 cable duct
 - Mounting material

- How supplied**
Flat-packed kit

Dimensions

- Useable height 25 mm
- Useable depth 80 mm

Material

Sheet steel

Finish

Powder-coated, RAL 9006, white aluminum

Model	for width	Order no.	UP
Straight	1550	04.300.410.9	1 unit
Straight	1950	04.300.411.9	1 unit
Circular segment	1950	04.300.412.9	1 unit
Circular segment	2350	04.300.413.9	1 unit

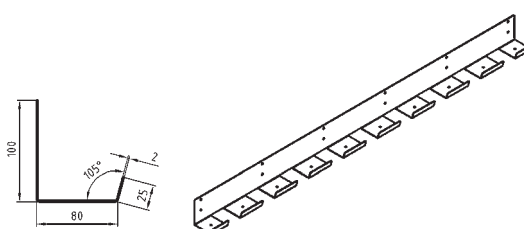

ERG00022

Accessories for Multi-Functional Rails

- Organizational elements, compatible design for Knürr multi-functional rails
- 430 mm console – also perfect as telephone stand

- Supply schedule**
- 1 cable duct
 - Mounting material

How supplied
Flat-packed kit

Material
Sheet steel

Finish
Powder-coated, RAL 9006, white aluminum

Model	Order no.	UP
Tray shelf DIN A4	04.300.400.9	1 unit
Box with note pad	04.303.103.9	1 unit
Tray shelf DIN A3	04.300.401.9	1 unit
Tray console 430 mm	04.303.106.9	1 unit
Tray console high 430 mm	04.303.107.9	1 unit
CD rack	04.300.402.9	1 unit
Magazine file DIN A4	04.303.110.9	1 unit



DAC20082

Tray shelf

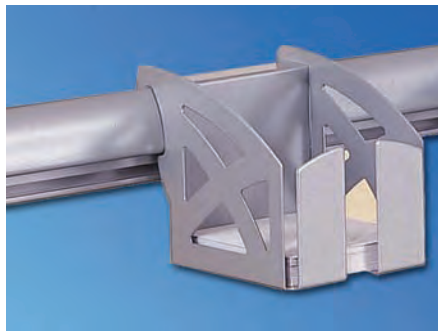

DAC20089

Box with note pad

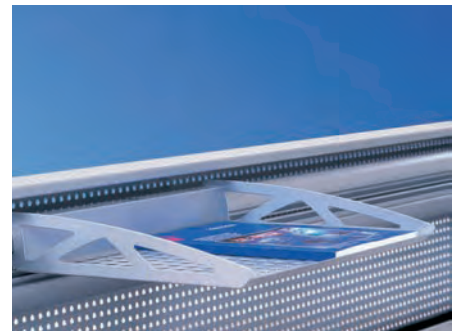

DAC00600

Tray shelf DIN A3



DAC20091

Tray console 430 mm



DAC80101

Tray console high 430 mm



DAC20083

CD rack

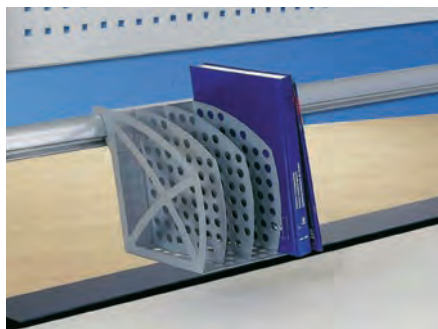

DAC20090

Magazine file DIN A4

Dimensions in mm: W= Width
H = Height
D = Depth
h = Installation height
d = Useful depth
L = Length

HU = Standard height unit, 1 HU = 44.45 mm
19" = 482.6 mm, (ideal for 19" components in acc. with DIN 41494)
UP = Unit of packaging
kg = Weight

Conversion: 1 mm = 0.03937 inch
1 kg = 2.2046 pound

Replace 'x' with the number of your color choice



SYN20020

Knürr SynergyWall®

Strong points

- **Functionality and style:** A product family for uniform equipment and furnishing in the control room in a full-coverage modern design.
- **Spacious cable management** with plenty of space for switches, cables and power supplies. Completely covered from screen through to raised floor.
- **Modular setup** – industrially produced modules can be upgraded and added to at all times; available to buy for many years to come.

■ Application areas for the Knürr SynergyWall®

- TV studios, news studios
- Process display in control rooms, control and measuring stations
- Network Operation Centers (NOCs)
- Data centers – computer monitoring
- Operation control centers – police, fire department, rescue services
- Municipal traffic monitoring
- Security systems, video monitoring
- Airport and train station information terminals
- Reception areas

■ Practical benefits

- Quick and easy to set up
- Monitor change: Effortlessly without any tools – simply hang on monitors!
- Highest possible stability, even with large span widths
- For all monitor sizes; different sizes can also be mixed
- Straight wall or cockpit solution (10°)
- Low installation depth/lower space requirement – good fit for small control rooms
Option: Without foot stabilizer at the rear
- The monitor wall can be positioned in the room, regardless of what the room is made of
- Optional rear and front panel covers provide optimum protection for cables and plugs
- Optional pedestals provide space for computers, power supplies and documentation
- Extension option with short cross extrusion for additional displays
- Monitors can swivel up to 15° in four positions



SYN20021

Knürr SynergyWall® complete configuration

A complete configuration with four public displays – 1,016 mm (40")
Ready configured for immediate use

Material

- Side panels – extruded aluminum with top cover, sheet steel side panel covers and foot stabilizer, powder-coated
- Crosspieces – extruded aluminum, powder-coated
- Large monitor holder – sheet steel, powder-coated

Finish

- Side panel aluminum extrusions, cross extrusions and large monitor holder: RAL 9006 white aluminum
- Side panel covers, foot stabilizer and side panel top cover: RAL 7021 dark gray

Dimensions

- Total width – 2,110 mm
- Clear width – 1,890 mm
- Side panel: height, 2,400 mm; depth, 290 mm; width, 107 mm

Supply schedule

- 2 side panels, with integrated vertical cable routing and foot stabilizers front and rear for highest possible stability
- 2 crosspieces for fixing the TFT adapter; with integrated horizontal cable routing
- 8 large monitor holders, tiltable to 15°
- 4 public displays, LCD, 1,016 mm (40")
(Make: Subject to manufacturer and technical changes due to short product cycles on the display market.)
- Network cable and VGA cable for 4 LCD monitors
- Mounting material

How supplied

- Flat-packed kit, partially assembled

W	H	Order no.	UP
2110	2400	04.102.030.9	



SYN20023

Knürr SynergyWall® Basic Frame

- Easy flat screen mounting between the monitor wall vertical extrusions
- Stable monitor hang-on with adjustable angle flat screen holders

Material

- Side panels – extruded aluminum with top cover, sheet steel side panel covers and foot stabilizer, powder-coated
- Crosspieces – extruded aluminum, powder-coated
- Large monitor holder – sheet steel, powder-coated

Finish

- Side panel aluminum extrusions, cross extrusions and large monitor holder: RAL 9006 white aluminum
- Side panel covers, foot stabilizer and side panel top cover: RAL 7021 dark gray

Dimensions

- Total width – 2,110 mm
- Clear width – 1,890 mm
- Side panel: height, 2,400 mm; depth, 290 mm; width, 107 mm

Note

- Further sizes and variations possible on request

Supply schedule

- 2 side panels, with integrated vertical cable routing and foot stabilizers front and rear for highest possible stability
- 2 crosspieces for fixing the TFT adapter; with integrated horizontal cable routing
- 8 large monitor holders, for four public displays, 1,016 mm (40"), tiltable to 15° in four positions
- Mounting material

How supplied

- Flat-packed kit, partially assembled

W	H	Order no.	UP
2110	2400	04.102.032.9	



SYN20023

Knürr SynergyWall® Side Panel

Design harmonized with Knürr SynergyConsole®. Spacious cable management with plenty of space for switches, cables and power supplies. Economically integrated cable routing. Split covers inside for easy cable routing; full on the outside. Long foot stabilizer for freely placing the panel in the room, or without foot stabilizer at the rear for wall positioning. T-slots outside for connecting cross supports and inside for mounting Knürr DI-Strip® socket strips and cable routing elements.

- Material**
- Extruded aluminum, powder-coated
 - Covers and foot stabilizer: Sheet steel, powder-coated

- Finish**
- Extruded aluminum, RAL 9006 white aluminum
 - Sheet steel components, RAL 7021 dark gray
- Dimensions**
- Height, 2,400 mm
Width, 107 mm
Depth, 290 mm
Foot stabilizer: Depth 1,200 mm or 600 mm
Width, 129 mm

- Supply schedule**
- 1 side panel
- How supplied**
- Preassembled

W	H		Order no.	UP
107	2400		04.102.035.9	1 unit
107	2400	foot stabilizer, short	04.102.036.9	1 unit



SYN20022

Knürr SynergyWall® Cross Support

For straight linking or in 10° angle
Extruded aluminum stable cross support
Depth-adjustable for optimum monitor arrangement
Spacious cable management with plenty of space for switches, cables and power supplies. Economical cable routing integrated in the cross support. With T-slots for mounting Knürr DI-STRIP® socket strips and cable routing elements.
New: Short, stable cross extrusion, for small displays.
Internal or external on the side panels, and depth adjustable.

- Material**
- Cross extrusion: Extruded aluminum, powder-coated
 - Adapter plates – aluminum, powder-coated

- Finish**
- RAL 9006 white aluminum
- Dimensions**
- Height: 120 mm
External depth: 60 mm
Width: 1,900 mm,
for 2 displays 1,016 mm (40")
- Supply schedule**
- 1 cross extrusion
2 adapter plates for connecting on the side panels
Cross support length – 400 mm:
1 adapter plate, 1 closing panel
Mounting material
- How supplied**
- Flat-packed kit

W	H	D		Order no.	UP
1900	120	60	Complete cross support, straight	04.102.040.9	1 unit
1900	120	60	Complete cross support, 10° linking	04.102.041.9	1 unit
400	120	60	Cross support, short	04.102.042.9	1 unit



SYN20016

Dimensions in mm: W= Width
H = Height
D = Depth
h = Installation height
d = Useful depth
L = Length

HU = Standard height unit, 1 HU = 44.45 mm
19"= 482.6 mm,
(ideal for 19" components in acc. with DIN 41494)
UP = Unit of packaging
kg = Weight

Conversion:

1 mm = 0.03937 inch
1 kg = 2.2046 pound

Replace 'x' with the number of your color choice



SYN20018



SYN20017

Knürr SynergyWall® Monitor Holder

VESA adapter, quick and easy to hang on
With safety screws against unintentional removal
Screw on to the monitor – hang on – done!
Angle adjustable up to 15° in three stages

Material/finish
Sheet steel, powder-coated

Finish
RAL 9006 white aluminum

Supply schedule
1 monitor holder
Mounting material

How supplied
Pre-assembled

Note
Large monitor holder: For display sizes
762 mm (30") to 1,651 mm (65")
Two monitor holders are required for each
display
Small monitor holder: With VESA adapter
75 mm/100 mm

	Order no.	UP
Large monitor holder	04.102.038.9	1 unit
Small monitor holder	04.102.039.9	1 unit

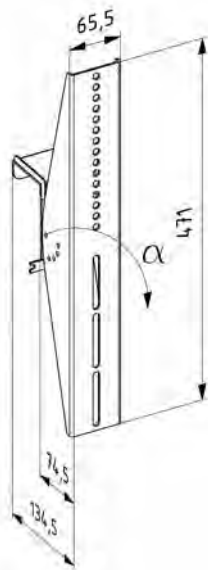

SYN20098

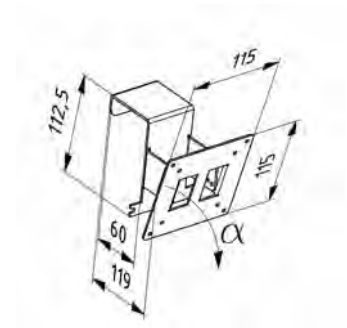

SYN20099



WAG20024

ICT Mobile

- For system and maintenance work in control centers
- Can be used, for example, as individual workstation, hot desk, test station, emergency workstation

Supply schedule

- 1 Knürr MetraMobil® basic rack
- 1 worktop with handle
- 1 keyboard extension
- 1 anti-slip mat set
- 1 cable management set, consisting of:
 - Knürr Di-Strip® socket strip 4-piece, without switch
 - Strain relief
 - 2 cable reel elements
 - 1 TFT swivel arm, E type
 - 1 480 mm (19") flat screen

How supplied

Flat pack, partially assembled

Finish

- Base unit, drawers, worktop – RAL 7016, anthracite gray
- Vertical extrusions – RAL 9006, white aluminum
- Handle – RAL 9011, graphite black

Flat screen subject to technical changes

W	H	D	Order no.	UP
550	1406 + 900	580	00.711.005.9	1 unit



WAG20026

LCD Mobile

- For LCD monitors to 1020 mm (40")
- Effortless moving with castors Ø 125 mm
- Trolley load capacity – up to 210 kg
- Vertical cable duct for safe monitor cable routing

Supply schedule

- 1 Knürr DacoMobile®
- 1x mounting rail for flat screen supports
- 1x cross extrusion for hardening at the top
- 2x vertical cable duct
- 1x drawer H 150 mm

How supplied

Flat-packed kit

Note

Monitor is screwed together directly on mounting rail (not swivelling)
Monitor is not included in the supply schedule

Dimensions

- mounting rail for flat screen supports VESA 200x200

Finish

- Extrusions, rockers, handle, cross extrusion – RAL 7021, dark gray
- Vertical cable duct, drawer – RAL 7035, light gray

W	H	D	Order no.	UP
763	1915	685	00.128.528.9	1 unit



Emerson Network Power is the global technology leader in numerous areas, and a recognized expert in helping to secure business-critical processes, and therefore contributes to "business-critical continuity." A whole range of the most varied applications, including the tried and tested Knürr rack system solutions and the accompanying thermal management, ensures the required network stability with maximum technological adaptability at the same time.

Knürr system solutions in the world of information and network technology are part of an adaptive architecture from Emerson Network Power, which flexibly adapts to changes concerning security, high-density and all associated capacities. Companies are provided sustainable and long-term benefits from the high IT availability, operative flexibility and impressive reduction in investment and operating costs.

The Knürr Technical Furniture business unit develops, produces and distributes technical workstation systems for control consoles, operation control centers and electronics labs, as well as mobile equipment carriers for the automotive and medical technology industries.

Knürr AG is recognized around the world as one of the leading developers, manufacturers and distributors of rack and enclosure platforms in the indoor and outdoor area, including all relevant active/passive components in 19" construction and the technologies associated with it. Knürr is part of Emerson Network Power.

Knürr is certified in accordance with EN ISO 9001 and EN ISO 14001, and its quality management continuously guarantees the highest standards in all areas of the company.

Emerson Network Power

The global leader in enabling business-critical continuity

AC Power Systems	Embedded Power	Power Switching & Controls	Site Monitoring
Connectivity	Integrated Cabinet Solutions	Precision Cooling	Surge & Signal Protection
DC Power Systems	Outside Plant	Services	Rack & Enclosure Systems

Knürr logo, Emerson Network Power and the Emerson Network Power logo are trademarks and service marks of Emerson Electric Co. ©2009 Emerson Electric Co.

Knürr AG Global Headquarters

Mariakirchener Straße 38
94424 Arnstorf • Germany
Tel. +49 (0) 87 23 / 27 - 0
Fax +49 (0) 87 23 / 27 - 154
info@knuerr.com

Knürr Technical Furniture GmbH Business Unit

Hauptstraße 35
94439 Münchsdorf • Germany
Tel. +49 (0) 87 23 / 28 - 0
Fax +49 (0) 87 23 / 28 - 138
furniture@knuerr.com

Local contacts, please visit:

www.knuerr.com
www.emerson.com
www.technical-furniture.com

While every precaution has been taken to ensure accuracy and completeness in this literature, Knürr AG assumes no responsibility, and disclaims all liability for damage resulting from use of this information or for any errors or omissions.

©2009 Knürr AG. All rights reserved throughout the world. Specifications subject to change without notice.

All names referred to are trademarks or registered trademarks of their respective owners.

©Knürr and the Knürr logo are registered trademarks of Knürr AG.

EmersonNetworkPower.com