

ITEM NO.	DESCRIPTION	QTY	
1	MAX BT ADPT, SNGL, WHITE	1	1
2	JACK, MX6, FLAT, 8 POSITION, WHITE	1	-
3	CDV, DDDR, MX5, MX6, FLAT, 8P, WHITE	1	-
4	CDV, TERM, CAP, CT/MX6	1	-
5	ICON, CT, ICON, DESIG-TAG, W, CYC	1	-
-	POL YBAG	1	1
-	CARTON	1/20	1/30
		MX-BT-KIT-02	MX-BT-02

REV.	ECO NO.	REVISIONS	BY	DATE	APVD.
A	1944	NEW RELEASE	HZ	06/11/08	DG 8/18/08

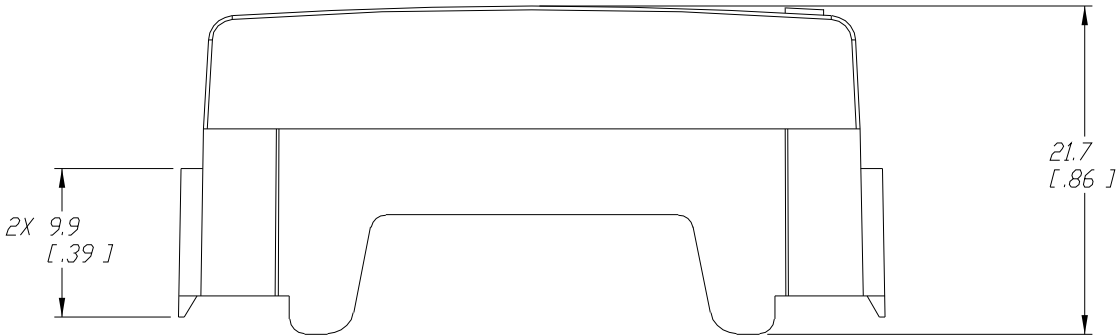
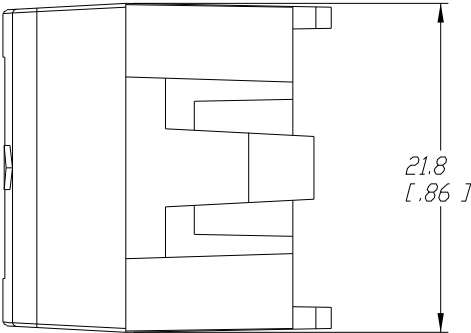
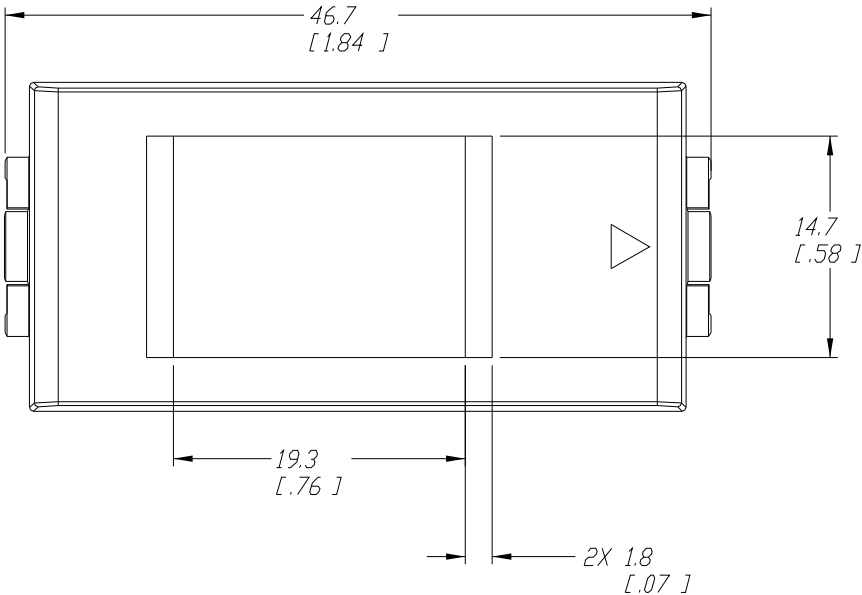

MX-BT-(XXX)-02

COLOR
02=WHITE

KIT=ASSEMBLED WITH FLAT UTP MAX OUTLET
BLANK=WITHOUT OUTLET*
*(SEE NOTES FOR OTHER COMPATIBLE MAX MODULES)

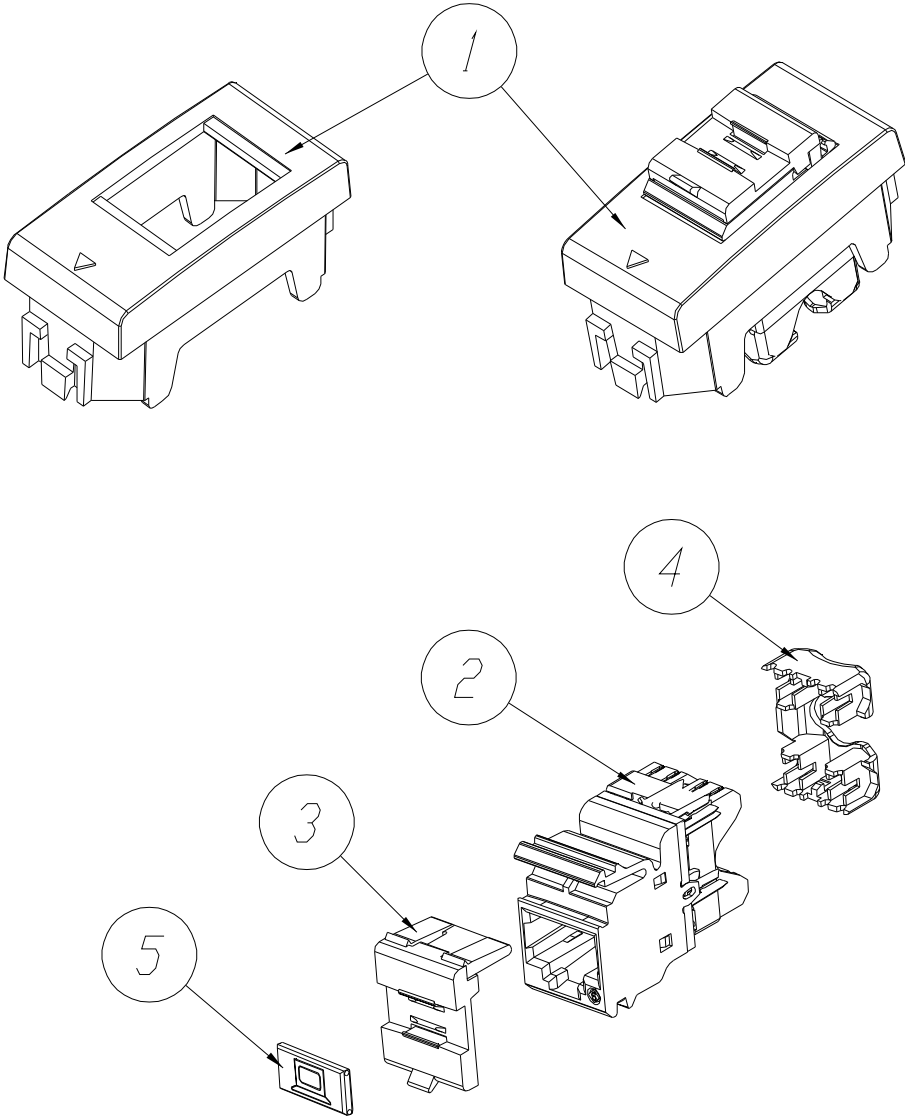

- NOTES:
1. MATERIAL: FLAME RETARDANT THERMOPLASTIC
 2. CONTACT A SIEMON COMPANY CUSTOMER SERVICE REPRESENTATIVE FOR ADDITIONAL INFORMATION.
 3. ADAPTERS ARE COMPATIBLE WITH BTICINO LIGHT AND INTERNATIONAL LIVING FRAMES.
 4. ADAPTER ACCEPTS FLAT,UTP,SCREEND AND MULTIMEDIA MAX MODULES AS WELL AS TERA OUTLETS.
 5. ADAPTER ALSO ACCEPT ANGLED PUNCHDOWN UTP MAX MODULES BUT CABLE AND TERMINATION CAP MUST BE INSTALLED PRIOR TO INSERTION INTO THE ADAPTER.
 6. CHECK FOR PROPER BEND RADIUS AND CABLE CLEARANCE LIMITATIONS WHEN CHOOSING MAX MODULES.

PROPRIETARY INFORMATION THIS DOCUMENT CONTAINS PROPRIETARY INFORMATION OF THE SIEMON COMPANY AND IS DELIVERED ON THE EXPRESSED CONDITIONS THAT IT IS NOT TO BE DISCLOSED OR REPRODUCED IN WHOLE OR PART, OR USED FOR MANUFACTURING FOR ANYONE OTHER THAN THE SIEMON COMPANY WITHOUT ITS WRITTEN CONSENT AND THAT NO RIGHT IS GRANTED TO DISCLOSE OR SO USE ANY INFORMATION CONTAINED IN SAID DOCUMENT.	THE SIEMON COMPANY 101 SIEMON COMPANY DRIVE WATERTOWN, CT 06795 (860) 945-4200 www.siemon.com			TITLE MX ADAPTER FOR BT FACEPLATE	
	TOLERANCES		DRAWN BY HZ	DATE 06/11/08	DWG. NO. B-9016666
	0 [.0]	±1 [±.04]	CHECKED BY DAVID G	DATE 06/15/08	
	0.0 [.00]	±0.5 [±.02]		ENGINEER HZ	DATE 06/11/08
	0.00 [.000]	±0.25 [±.01]	PART NO. MX-BT-(XXX)-02		
	ANGLE	1°	REV. A		
	(SEE TABLE)				
	ANSI Y14.5M-1982 OR ISO 1101, 129 & 3040				
	DIMENSIONS IN SQUARE BRACKETS ARE [in] ALL OTHER DIMENSIONS ARE MILLIMETERS.		DO NOT SCALE		SCALE 2:1
					SHEET 1 OF 1

CUSTOMER USE DRAWING