

Knürr Miracel®

19" Rack for

Network Applications

1.24 to 1.47

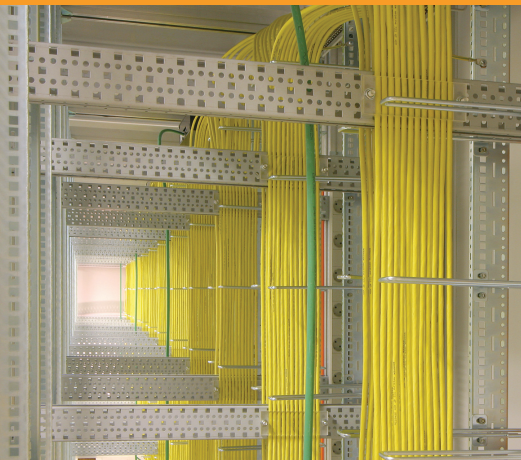

19" Network Rack

Knürr Miracel®

Strong points 1.25

Distribution Rack

Knürr Miracel® NS 25 1.28

Knürr Miracel® NS 26 1.30

Knürr Miracel® NS 19.8 1.31

Knürr Miracel® NS 19.6 1.32

Knürr Miracel® NO 19

Lab Rack 1.33

Knürr Miracel®

Basic Rack 1.34

Knürr Miracel®

NS 19.8 D 1.35

Knürr Miracel®

Without front door 1.36

Knürr Miracel® IP 55 1.37

Knürr Miracel® Accessories

Rack Connector 1.38

Extrusions 1.38

Mounting Adapters 1.39

U Tape Measure 1.39

Swing Frame 1.40

Doors 1.41

Locking Set 1.43

Earthing Set 1.43

Plinth 1.43

Castors 1.44

Bottom Cover 1.44

Side Panel 1.46

Rear Panel 1.46

Top Cover IP 55 1.47

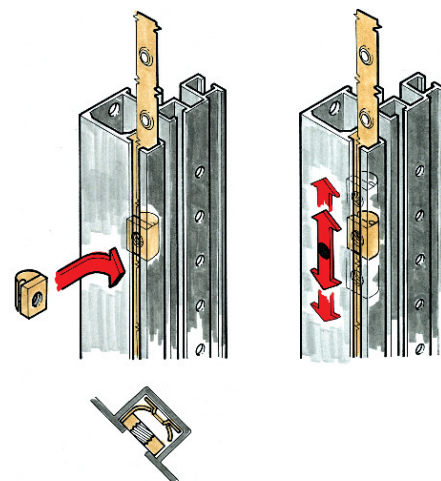

1 MIR00139



3 TEC00028



Knürr Miracel®
Strong points

1 Modular construction

Easy mounting, including all non-standard components – variable and in integrated 19" or 25 mm increments.

2 Forward-thinking

Security for the future and flexibility with integration of 19" and metric technology.

3 Expandable at all times

System expansions can be easily implemented while maintaining the IP protection rating.

4 Cable management

Guaranteed orderly and space-saving cable management. Adjustment to installation site; cable management can be selected from an extensive range of accessory components.

5 Flexible ventilation components

The correct ventilation solution is always provided by the corresponding selection of accessory components. This allows the airflow to be specially adapted to the built-in components. Through the perforated bottom covers, top covers and doors, for example.

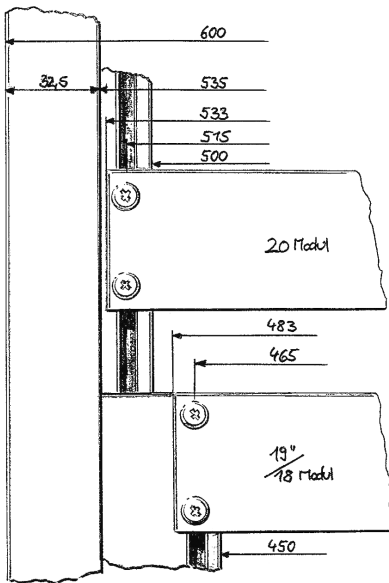

2 MIR20122



4 MEC20084



4 MIR00143

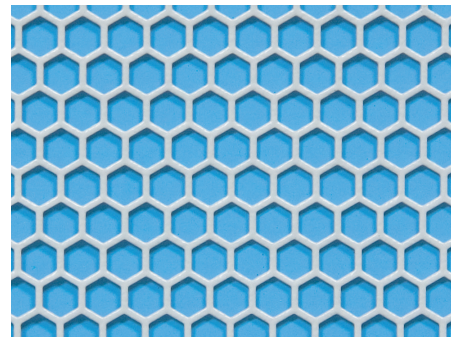

5 MIR20265



5 LUF20124

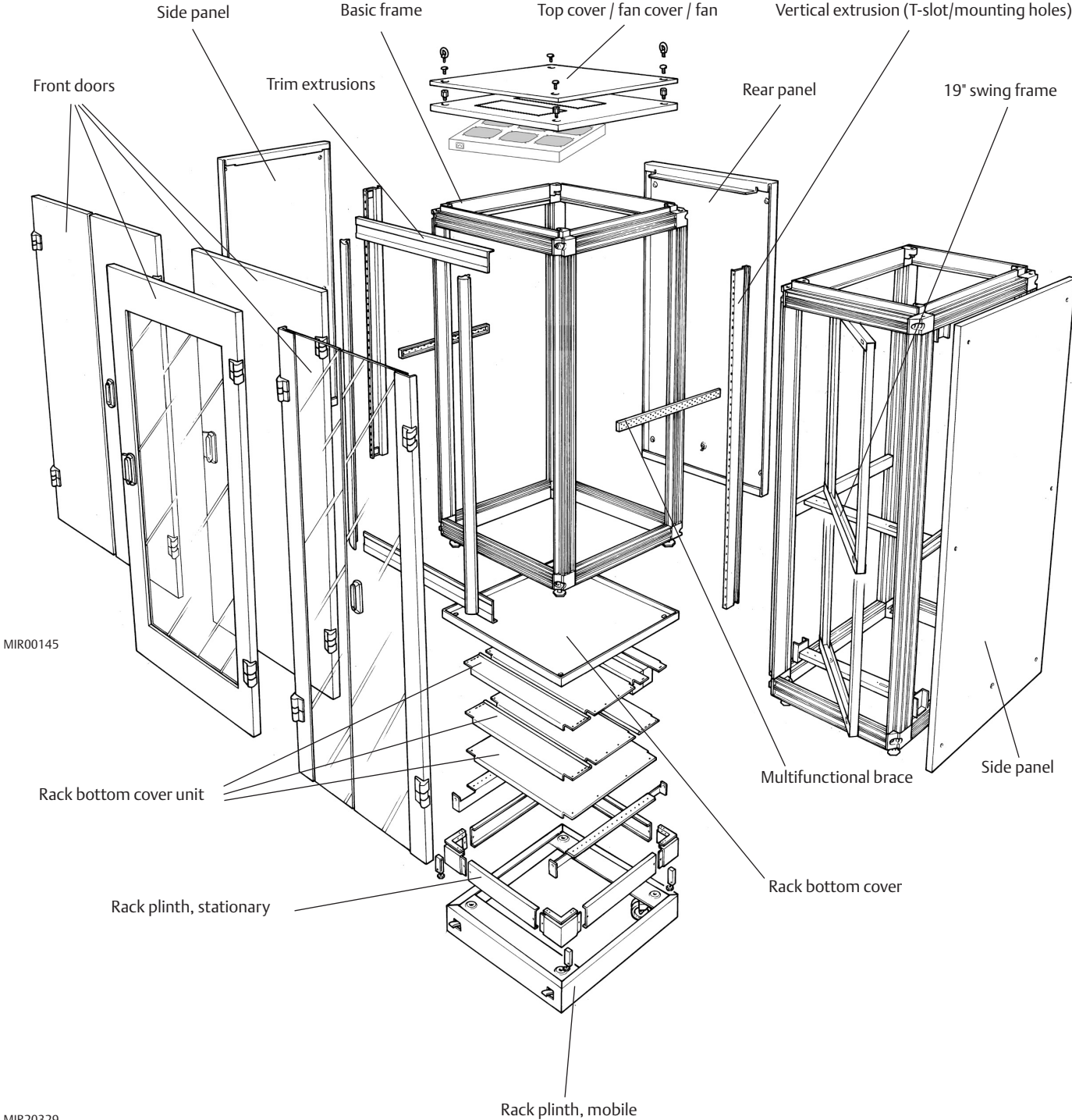

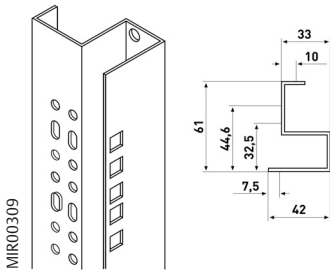

Vertical extrusion with mounting holes, steel for 19" racks

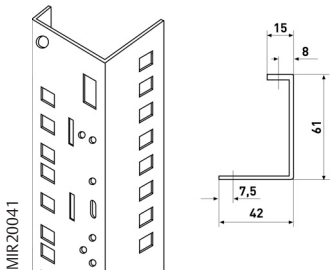

19" server extrusion

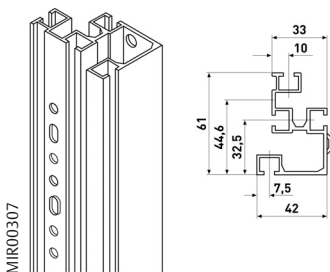

Vertical extrusion with T-slot, aluminum for 19" construction

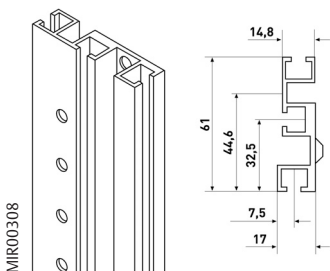

Vertical extrusion with T-slot, aluminum for metric construction, 20 module

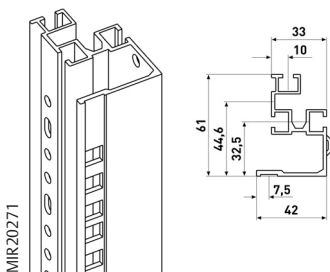

Vertical extrusion with mounting holes, aluminum for 19" racks

Knürr Miracel® 19" Rack Technical data

Material

- Extruded aluminum
- Corner piece, die-cast aluminum
- Covers, sheet steel, zinc-passivated
- Doors: sheet steel or with single safety glass panel, opening angle, over 180°

Installation dimensions in acc. with IEC297-3 and IEC917

- Height: 23 U / 37 U / 41 U / 46 U (1 U = 44.45 mm) 66 module / 74 module / 82 module (1 module = 25 mm)
- Width: 482.6 mm (19" construction) 535 mm (20" module construction)

Space solution

- 82% of the basic surface can be used as space for installation and cable routing
- Front jumpering space, 123 mm or 73 mm
- Door opening angle, 180°

Configurations

- Stationary, on leveling feet
- Stationary with plinth
- Mobile with plinth and snib

Finish /Color

- Basic frame, polished
- Optional: Door trim, black, RAL 9011
- Visible surface of covers, powder-coated, dark gray RAL 7021 or dark gray RAL 7021

Static load rating

- 5,000 N with stationary version
- 3,000 N with mobile plinth

Heat transfer

- Power loss with:
- Closed top cover, up to 500 W
 - Vent lid, up to 700 W

Tests according to version

- Vibration test in acc. with MIL-STD 810 E
- IP test in acc. with IEC 529
- UL test 1244
- NEMA 12 Standard
- EMC shielding attenuation in acc. with MIL-STD 285 (10 MHz - 30 MHz) and VG 95 373 Part 15 (30 MHz-1GHz)
- Vibration and shock test in acc. with ETS 300 019
- Seismic test, Bellcore (NEBS)TR-NWT 000063 Zone 4
- Earthing, VDE 0 100 T 540

Further standards and tests on request.

Rack suites

- To create a rack suite with "n" racks, you require:
- n-1 racks without side panels and 1 rack with side panels
 - In a rack suite, per connection you require one set of rack connectors

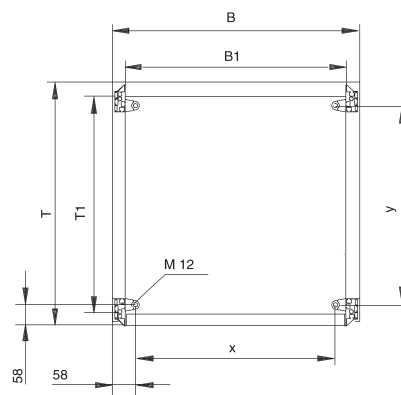

MIR00332

W [mm]	W1 [mm]	X [mm]
600	535	485
700	635	585
800	735	685
900	835	785

D [mm]	D1 [mm]	Y [mm]
600	530	485
800	730	685
900	830	785
1000	930	885
1200	1130	1085



MIR20301

Color: dark gray or light gray

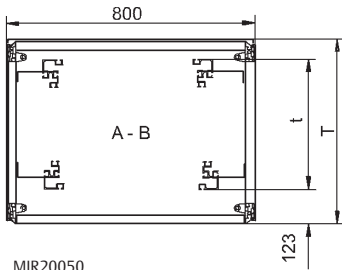

MIR20050

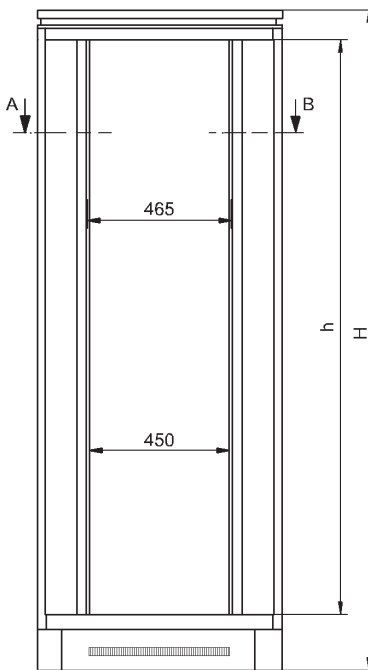

MIR20050

Dimensions in mm: W= Width, H= Height, D= Depth, h= installation height, d= useful depth, L= length, U= standard height unit, 1 U= 44.45 mm, UP= unit of packaging, kg= weight, Express item icon.

Conversion: 1 mm = 0.03937 inch, 1 kg = 2.2046 pound

Knürr Miracel® 19" Distribution Rack, NS 25 Width 800, front glass door, T-slot extrusions

- With fixed 19" installation on the front and rear for components in accordance with IEC297-3
- Installation of slot-in runners and 19" shelves possible
- Flexible assembly of the built-in units with T-slot
- Cable entry via plinth and top cover
- Cable entry on the top cover, can be completely removed at the rear, allowing top cover removal and replacement after cabling
- Dissipated heat discharge via raised fan roof.
- Top cover prepared for upgrading with CoolBlast® range fan units. This enables flexible adjustments to customer requirements.
- Door opening angle, 180°

Jumping space

At the front: 123 mm

Load rating

5000 N static

Protection rating

IP 40

Tests

- Earthing in acc. with VDE 0100 T 540
- Vibration test in acc. with MIL-STD 810 E
- IP test in acc. with DIN 40 050 / IEC 529

Material/finish

- Basic rack, extruded aluminum, polished
- Corner piece, die-cast aluminum, polished
- Doors, sheet steel, powder-coated texture
- Covers, zinc-passivated sheet steel, powder-coated texture
- Glass infill front door, single safety glass panel, 4 mm

- Multifunctional braces, sheet steel, zinc-plated

Color

- Final digit of order number .1: Visible surface of covers, RAL 7035 light gray
- Final digit of order number .8: Visible surfaces of the covers, RAL7021 dark gray

Supply schedule

- 1 basic rack
- 4" aluminum vertical extrusions with T-slot and increment slide for spring nut M5
- 2 multifunctional braces for cable clamping and universal mounting options
- 2 side panels with quick connectors
- 1 top cover with cable entry (three-piece sliding plates, can also be opened completely), prepared for upgrading CoolBlast® fan units
- 1 front door, single, single safety glass panel, with handle and mounting for cylinder lock
- 1 rear door, single, sheet steel, with handle and mounting for cylinder lock
- 1 plinth for cable management on the side and rear with leveling feet (0-25 mm)
- 2 plinth panels for front and rear, with vent slots and fixing for filter mat
- 2 plinth panels, closed
- 1 complete earthing test (VDE 0100)

How supplied

Assembled

W	H	D	U	h	d	kg	Model	Order no.	UP
800	2120	600	41	1852	365	112	With side panels/RAL 7035	01.136.044.1	1 unit
800	2120	600	41	1852	365	112	With side panels/RAL 7021	01.136.044.8	1 unit
800	2120	800	41	1852	565	120	With side panels/RAL 7035	01.136.050.1	1 unit
800	2120	800	41	1852	565	120	With side panels/RAL 7021	01.136.050.8	1 unit
800	2320	800	46	2052	565	130	With side panels/RAL 7035	01.136.051.1	1 unit
800	2320	800	46	2052	565	130	With side panels/RAL 7021	01.136.051.8	1 unit
800	2120	900	41	1852	665	124	With side panels/RAL 7035	01.136.056.1	1 unit
800	2120	900	41	1852	665	124	With side panels/RAL 7021	01.136.056.8	1 unit
800	2320	900	46	2052	665	134	With side panels/RAL 7035	01.136.057.1	1 unit
800	2320	900	46	2052	665	134	With side panels/RAL 7021	01.136.057.8	1 unit
800	2120	1000	41	1852	740	140	With side panels/RAL 7035	01.127.970.1	1 unit
800	2120	1000	41	1852	740	140	With side panels/RAL 7021	01.127.970.8	1 unit
800	2320	1000	46	1852	740	140	With side panels/RAL 7035	01.127.971.1	1 unit
800	2320	1000	46	1852	740	140	With side panels/RAL 7021	01.127.971.8	1 unit
800	2120	600	41	1852	365	103	No side panels/RAL 7035	01.136.244.1	1 unit
800	2120	600	41	1852	365	103	No side panels/RAL 7021	01.136.244.8	1 unit
800	2120	800	41	1852	565	109	No side panels/RAL 7035	01.136.250.1	1 unit
800	2120	800	41	1852	565	109	No side panels/RAL 7021	01.136.250.8	1 unit
800	2120	900	41	1852	665	118	No side panels/RAL 7035	01.136.256.1	1 unit
800	2120	900	41	1852	665	118	No side panels/RAL 7021	01.136.256.8	1 unit
800	2120	1000	41	1852	740	128	No side panels/RAL 7035	01.127.975.1	1 unit
800	2120	1000	41	1852	740	128	No side panels/RAL 7021	01.127.975.8	1 unit



MIR20301

Color: dark gray or light gray

Knürr Miracel® 19" Distribution Rack, NS 25
Width 800, front glass door, 19" mounting hole extrusions

- With fixed 19" installation on the front and rear for components in accordance with IEC297-3
- Installation of slot-in runners and 19" shelves possible
- Cable entry via plinth and top cover
- Cable entry on the top cover, can be completely removed at the rear, allowing top cover removal and replacement after cabling
- Dissipated heat discharge via raised fan roof.
- Top cover prepared for upgrading with CoolBlast® range fan units. This enables flexible adjustments to customer requirements.
- Door opening angle, 180°

Jumping space
 At the front: 123 mm

Load rating
 5000 N static

Protection rating
 IP 40

- Tests**
- Earthing in acc. with VDE 0100 T 540
 - Vibration test in acc. with MIL-STD 810 E
 - IP test in acc. with DIN 40 050 / IEC 529

- Material/finish**
- Basic rack, extruded aluminum, polished
 - Corner piece, die-cast aluminum, polished
 - Doors, sheet steel, powder-coated texture
 - Covers, zinc-passivated sheet steel, powder-coated texture
 - Glass infill front door, single safety glass panel, 4 mm
 - Multifunctional braces, sheet steel, zinc-plated

- Color**
- Final digit of order number .1:
 Visible surface of covers, RAL 7035 light gray
 - Final digit of order number .8:
 Visible surfaces of the covers, RAL7021 dark gray

- Supply schedule**
- 1 basic rack
 - 4 19" vertical extrusions, sheet steel with mounting holes
 - 2 multifunctional braces for cable clamping and universal mounting options
 - 2 side panels with quick connectors
 - 1 top cover with cable entry (three-piece sliding plates, can also be opened completely), prepared for upgrading CoolBlast® fan units
 - 1 front door, single, single safety glass panel, with handle and mounting for cylinder lock
 - 1 rear door, single, sheet steel, with handle and mounting for cylinder lock
 - 1 plinth for cable management on the side and rear with leveling feet (0-25 mm)
 - 2 plinth panels for front and rear, with vent slots and fixing for filter mat
 - 2 plinth panels, closed
 - 1 complete earthing test (VDE 0100)

How supplied
 Assembled

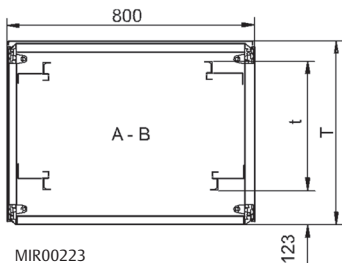

MIR00223

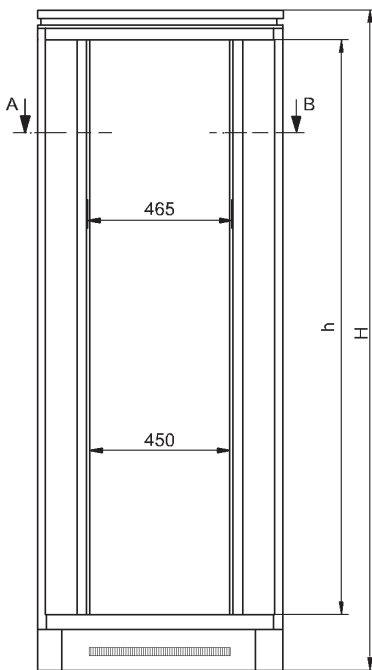

MIR20050

Dimensions in mm: W= Width, H= Height, D= Depth, h= installation height, d= useful depth, L= length, U= standard height unit (1 U= 44.45 mm), UP= unit of packaging, kg= weight, Express item

Conversion: 1 mm = 0.03937 inch, 1 kg = 2.2046 pound

W	H	D	U	h	d	kg	Model	Order no.	UP
800	2120	600	41	1852	365	112	With side panels/RAL 7035	01.133.040.1	1 unit
800	2120	600	41	1852	365	112	With side panels/RAL 7021	01.133.040.8	1 unit
800	2120	800	41	1852	565	120	With side panels/RAL 7035	01.133.041.1	1 unit
800	2120	800	41	1852	565	120	With side panels/RAL 7021	01.133.041.8	1 unit
800	2320	800	46	2052	565	130	With side panels/RAL 7035	01.133.042.1	1 unit
800	2320	800	46	2052	565	130	With side panels/RAL 7021	01.133.042.8	1 unit
800	2120	900	41	1852	665	124	With side panels/RAL 7035	01.133.043.1	1 unit
800	2120	900	41	1852	665	124	With side panels/RAL 7021	01.133.043.8	1 unit
800	2320	900	46	2052	665	134	With side panels/RAL 7035	01.133.044.1	1 unit
800	2320	900	46	2052	665	134	With side panels/RAL 7021	01.133.044.8	1 unit
800	2120	1000	41	1852	740	140	With side panels/RAL 7035	01.133.045.1	1 unit
800	2120	1000	41	1852	740	140	With side panels/RAL 7021	01.133.045.8	1 unit
800	2120	600	41	1852	365	103	No side panels/RAL 7035	01.133.046.1	1 unit
800	2120	600	41	1852	365	103	No side panels/RAL 7021	01.133.046.8	1 unit
800	2120	800	41	1852	565	109	No side panels/RAL 7035	01.133.047.1	1 unit
800	2120	800	41	1852	565	109	No side panels/RAL 7021	01.133.047.8	1 unit
800	2120	900	41	1852	665	118	No side panels/RAL 7035	01.133.048.1	1 unit
800	2120	900	41	1852	665	118	No side panels/RAL 7021	01.133.048.8	1 unit
800	2120	1000	41	1852	740	128	No side panels/RAL 7035	01.133.049.1	1 unit
800	2120	1000	41	1852	740	128	No side panels/RAL 7021	01.133.049.8	1 unit



MIR20302

Color: dark gray or light gray

Knürr Miracel® 19" Distribution Rack, NS 26 Width 800, front glass door, mounting hole extrusions

- With fixed 19" installation on the front and rear for components in accordance with IEC297-3
- Installation of slot-in runners and 19" shelves possible
- Top cover prepared for upgrading with CoolBlast® range fan units. This enables flexible adjustments to customer requirements.
- Door opening angle, 180°

■ Jumpering space

At the front: 123 mm

■ Load rating

5000 N static

■ Protection rating

IP 40

■ Tests

- Earthing in acc. with VDE 0100 T 540
- IP test in acc. with DIN 40 050 / IEC 529

■ Material/finish

- Basic rack, extruded aluminum, polished
- Corner piece, die-cast aluminum, polished
- Covers, zinc-passivated sheet steel, powder-coated texture
- Doors, sheet steel, powder-coated texture, glass infill, front door, single safety glass panel, 4 mm
- Multifunctional braces and 19" extrusions, sheet steel, zinc-passivated

■ Color

- Final digit of order number .1:
Visible surface of covers, RAL 7035 light gray
- Final digit of order number .8:
Visible surfaces of the covers, RAL7021 dark gray

■ Supply schedule

- 1 basic rack
- 4 19" vertical extrusions, sheet steel with mounting holes
- 2 multifunctional braces for cable clamping and universal mounting options
- 2 side panels with quick connectors
- 1 top cover with cable entry (three-piece sliding plates, can also be opened completely), prepared for upgrading CoolBlast® fan units
- 1 front door, single, single safety glass panel, with handle and mounting for cylinder lock
- 1 rear door, single, sheet steel, with handle and mounting for cylinder lock
- 1 complete earthing test (VDE 0100)
- 4 leveling feet

■ How supplied

Assembled

■ Note

- Not available with double doors
- Not available with bottom covers

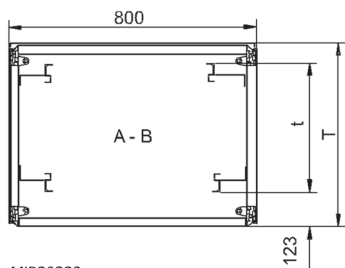

MIR20223

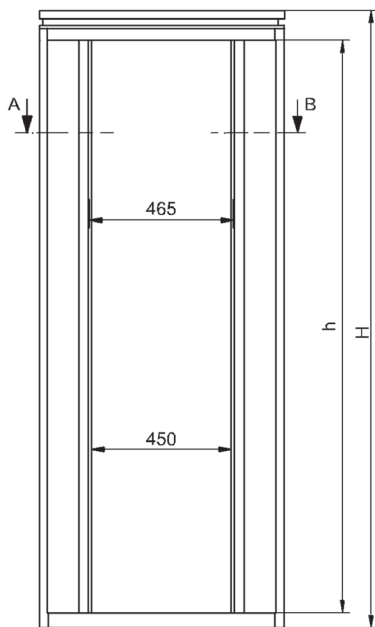

MIR20223

W	H	D	U	h	d	kg	Model	Order no.	UP
800	2000	600	42	1900	365	108	With side panels/RAL 7035	01.136.274.1	1 unit
800	2000	600	42	1900	365	108	With side panels/RAL 7021	01.136.274.8	1 unit
800	2000	800	42	1900	565	116	With side panels/RAL 7035	01.136.280.1	1 unit
800	2000	800	42	1900	565	116	With side panels/RAL 7021	01.136.280.8	1 unit
800	2200	800	47	2100	565	126	With side panels/RAL 7035	01.136.281.1	1 unit
800	2200	800	47	2100	565	126	With side panels/RAL 7021	01.136.281.8	1 unit
800	2000	900	42	1900	665	120	With side panels/RAL 7035	01.136.286.1	1 unit
800	2000	900	42	1900	665	120	With side panels/RAL 7021	01.136.286.8	1 unit
800	2200	900	47	2100	665	120	With side panels/RAL 7035	01.136.287.1	1 unit
800	2200	900	47	2100	665	120	With side panels/RAL 7021	01.136.287.8	1 unit
800	2000	600	42	1900	365	99	No side panels/RAL 7035	01.136.300.1	1 unit
800	2000	600	42	1900	365	99	No side panels/RAL 7021	01.136.300.8	1 unit
800	2000	800	42	1900	565	105	No side panels/RAL 7035	01.136.306.1	1 unit
800	2000	800	42	1900	565	105	No side panels/RAL 7021	01.136.306.8	1 unit
800	2000	900	42	1900	665	116	No side panels/RAL 7035	01.136.312.1	1 unit
800	2000	900	42	1900	665	116	No side panels/RAL 7021	01.136.312.8	1 unit

Dimensions in mm: W= Width
H= Height
D= Depth
h= installation height
d= useful depth
L= length

U = standard height unit
1 U = 44.45 mm
UP = unit of packaging
kg = weight

= Express item

Conversion: 1 mm = 0.03937 inch 1 kg = 2.2046 pound



MIR20303

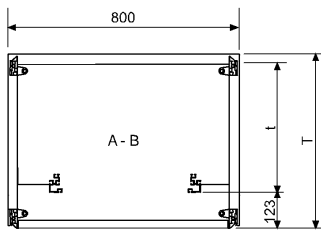

MIR00607

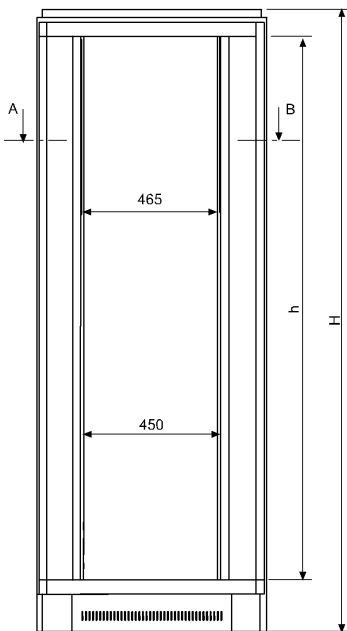

MIR00607

Dimensions in mm: W= Width, H= Height, D= Depth, h= installation height, d= useful depth, L= length, U= standard height unit, 1 U= 44.45 mm, UP= unit of packaging, kg= weight, Express item

Conversion: 1 mm = 0.03937 inch, 1 kg = 2.2046 pound

Knürr Miracel® 19" Distribution Rack, NS 19.8 Width 800, front glass door (Two 19" extrusions)

- With fixed 19" installation on the front for components in acc. with IEC 297-3
- Flexible assembly of the built-in units with T-slot
- Cable entry via plinth and top cover
- Cable entry on the top cover, can be completely removed at the rear, allowing top cover removal and replacement after cabling
- Dissipated heat discharge via raised fan roof
- Top cover prepared for upgrading with CoolBlast® range fan units. This enables flexible adjustments to customer requirements.
- Door opening angle, 180°

Jumping space
At the front: 123 mm

Load rating
5000 N static

Protection rating
IP 40

- Tests**
- Earthing in acc. with VDE 0100 T 540
 - Vibration test in acc. with MIL-STD 810 E
 - IP test in acc. with DIN 40 050 / IEC 529

- Material/finish**
- Basic rack, extruded aluminum, polished
 - Corner piece, die-cast aluminum, polished
 - Covers, zinc-passivated sheet steel, powder-coated texture
 - Doors, sheet steel, powder-coated texture, glass infill, front door, single safety glass panel, 4 mm
 - Multifunctional braces, sheet steel, zinc-plated

Color
Visible surface of covers
RAL 7035 light gray

- Supply schedule**
- 1 basic rack
 - 2 19" aluminum vertical extrusions with T-slot and increment slide for spring nut M5
 - 2 multifunctional braces for cable clamping and universal mounting options
 - 1 raised top cover with cable entry (three-piece sliding plates, can also be opened completely), prepared for upgrading CoolBlast® fan units
 - 1 front door, single or double, single safety glass panel, with handle and mounting for cylinder lock
 - 1 rear door, single or double, sheet steel, with handle and mounting for cylinder lock
 - 2 side panels with quick connectors (according to model)
 - 1 plinth for cable management on the side and rear with leveling feet (0-25 mm)
 - 2 side plinth panels, closed (according to model)
 - 2 plinth panels for front and rear, with vent slots and fixing for filter mat
 - 1 complete earthing test (VDE 0100)

How supplied
Assembled

W	H	D	U	h	d	kg	Model	Order no.	UP
800	1320	600	23	1052	435	78	Glass door, side panel	01.135.001.1	1 unit
800	1920	600	37	1652	435	103	Glass door, side panel	01.135.003.1	1 unit
800	2120	600	41	1852	435	112	Glass door, side panel	01.135.004.1	1 unit
800	2320	600	46	2052	435	121	Glass door, side panel	01.135.005.1	1 unit
800	1320	800	23	1052	635	80	Glass door, side panel	01.135.019.1	1 unit
800	1920	800	37	1652	635	111	Glass door, side panel	01.135.021.1	1 unit
800	2120	800	41	1852	635	120	Glass door, side panel	01.135.022.1	1 unit
800	2320	800	46	2052	635	129	Glass door, side panel	01.135.023.1	1 unit
800	1320	600	23	1052	435	70	Glass door, no side panel	01.135.007.1	1 unit
800	1920	600	37	1652	435	95	Glass door, no side panel	01.135.009.1	1 unit
800	2120	600	41	1852	435	103	Glass door, no side panel	01.135.010.1	1 unit
800	2320	600	46	2052	435	112	Glass door, no side panel	01.135.011.1	1 unit
800	1320	800	23	1052	635	73	Glass door, no side panel	01.135.025.1	1 unit
800	1920	800	37	1652	635	101	Glass door, no side panel	01.135.027.1	1 unit
800	2120	800	41	1852	635	109	Glass door, no side panel	01.135.028.1	1 unit
800	2320	800	46	2052	635	118	Glass door, no side panel	01.135.029.1	1 unit
800	1320	800	23	1052	635	80	Double glass door, side panel	01.135.037.1	1 unit
800	1920	800	37	1652	635	111	Double glass door, side panel	01.135.039.1	1 unit
800	2120	800	41	1852	635	120	Double glass door, side panel	01.135.040.1	1 unit
800	2320	800	46	2052	635	121	Double glass door, side panel	01.135.041.1	1 unit
800	1320	800	23	1052	635	73	Double glass door, no side panel	01.135.043.1	1 unit
800	1920	800	37	1652	635	101	Double glass door, no side panel	01.135.045.1	1 unit
800	2120	800	41	1852	635	109	Double glass door, no side panel	01.135.046.1	1 unit
800	2320	800	46	2052	635	118	Double glass door, no side panel	01.135.047.1	1 unit



MIR20304

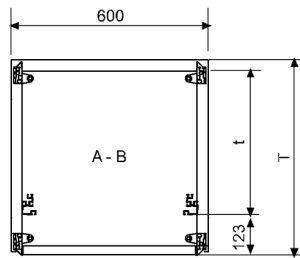

MIR00056

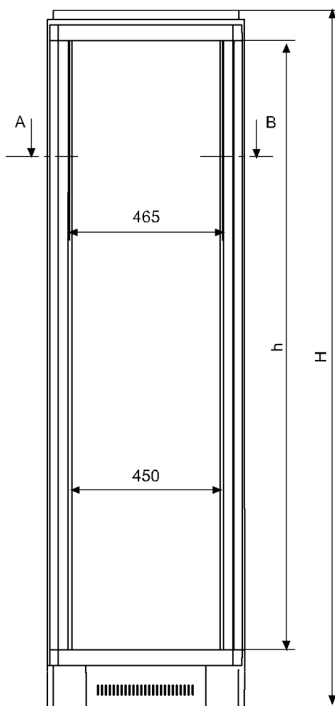

MIR00031

Dimensions in mm: W= Width, H= Height, D= Depth, h= installation height, d= useful depth, L= length, U= standard height unit (1 U= 44.45 mm), UP= unit of packaging, kg= weight, Express item

Conversion: 1 mm = 0.03937 inch, 1 kg = 2.2046 pound

Knürr Miracel® 19" Distribution Rack, NS 19.6 Width 600, with front glass door (Two 19" extrusions)

- With fixed 19" installation on the front for components in acc. with IEC 297-3
- Flexible assembly of the built-in units with T-slot
- Cable entry via plinth and top cover
- Cable entry on the top cover, can be completely removed at the rear, allowing top cover removal and replacement after cabling
- Dissipated heat discharge via raised fan roof.
- Top cover prepared for upgrading with CoolBlast® range fan units. This enables flexible adjustments to customer requirements.
- Door opening angle, 180°

Jumping space
At the front: 123 mm

Load rating
5000 N static

Protection rating
IP 40

- Tests**
- Earthing in acc. with VDE 0100 T 540
 - Vibration test in acc. with MIL-STD 810 E
 - IP test in acc. with DIN 40 050 / IEC 529

- Material/finish**
- Basic rack, extruded aluminum, polished
 - Corner piece, die-cast aluminum, polished
 - Covers, zinc-passivated sheet steel, powder-coated texture
 - Doors, sheet steel, powder-coated texture, glass infill, front door, single safety glass panel, 4 mm
 - Multifunctional braces, sheet steel, zinc-plated

Color
Visible surface of covers
RAL 7035 light gray

- Supply schedule**
- 1 basic rack
 - 2 19" aluminum vertical extrusions with T-slot and increment slide for spring nut M5
 - 2 multifunctional braces for cable clamping and universal mounting options
 - 1 raised top cover with cable entry (three-piece sliding plates, can also be opened completely), prepared for upgrading CoolBlast® fan units
 - 1 front door, single, single safety glass panel, with handle and mounting for cylinder lock
 - 1 rear door, single, sheet steel, with handle and mounting for cylinder lock
 - 2 side panels with quick connectors
 - 1 plinth for cable management on the side and rear with leveling feet (0-25 mm)
 - 2 side plinth panels, closed
 - 2 plinth panels for front and rear, with vent slots and fixing for filter mat
 - 1 complete earthing test (VDE 0100)

How supplied
Assembled

W	H	D	U	h	d	kg	Model	Order no.	UP
600	1320	600	23	1052	435	72	With side panel	01.135.109.1	1 unit
600	1920	600	37	1652	435	95	With side panel	01.135.111.1	1 unit
600	2120	600	41	1852	435	103	With side panel	01.135.112.1	1 unit
600	2320	600	46	2052	435	112	With side panel	01.135.113.1	1 unit
600	1320	800	23	1052	635	74	With side panel	01.135.127.1	1 unit
600	1920	800	37	1652	635	102	With side panel	01.135.129.1	1 unit
600	2120	800	41	1852	635	110	With side panel	01.135.130.1	1 unit
600	2320	800	46	2052	635	119	With side panel	01.135.131.1	1 unit
600	1320	600	23	1052	435	68	No side panel	01.135.115.1	1 unit
600	1920	600	37	1652	435	94	No side panel	01.135.117.1	1 unit
600	2120	600	41	1852	435	99	No side panel	01.135.118.1	1 unit
600	2320	600	46	2052	435	106	No side panel	01.135.119.1	1 unit
600	1320	800	23	1052	635	68	No side panel	01.135.133.1	1 unit
600	1920	800	37	1652	635	94	No side panel	01.135.135.1	1 unit
600	2120	800	41	1852	635	99	No side panel	01.135.136.1	1 unit
600	2320	800	46	2052	635	106	No side panel	01.135.137.1	1 unit



MIR20307

Miracel® 19" Lab Rack, NO 19
 With 2 x 19" T-slot extrusions (basis for rack widths 600 / 700 / 800)

- With fixed 19" installation on the front for components in acc. with IEC 297-3
- Flexible assembly of the built-in units with T-slot

■ **Jumpering space**
 At the front: 123 mm

■ **Load rating**
 5000 N static

- **Tests**
- Earthing in acc. with VDE 0100 T 540
 - Vibration test in acc. with MIL-STD 810 E

- **Material/finish**
- Basic rack, extruded aluminum, polished
 - Corner piece, die-cast aluminum
 - Multifunctional braces, sheet steel, zinc-plated

■ **Supply schedule**

- 1 basic rack
- 2 19" aluminum vertical extrusions with T-slot and increment slide for spring nut M5
- 2 multifunctional braces for cable clamping and universal mounting options
- 4 leveling feet (0-25 mm)

■ **How supplied**
 Assembled

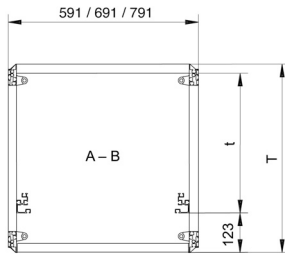

MIR00043a

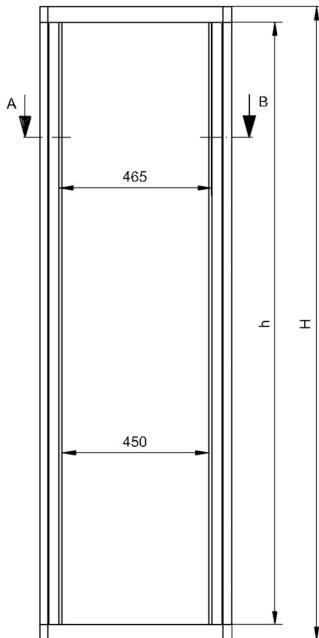

MIR20002

W	H	D	U	h	d	kg	Model	Order no.	UP
591	1196	585	23	1052	435	14		01.135.793.3	1 unit
591	1796	585	37	1652	435	16		01.135.795.3	1 unit
591	1996	585	41	1852	435	17		01.135.796.3	1 unit
591	2196	585	46	2052	435	18		01.135.797.3	1 unit
591	1196	785	23	1052	635	16		01.135.817.3	1 unit
591	1796	785	37	1652	635	18		01.135.819.3	1 unit
591	1996	785	41	1852	635	19		01.135.820.3	1 unit
591	2196	785	46	2052	635	20		01.135.821.3	1 unit
591	1196	885	37	1652	735	19		01.135.842.0	1 unit
591	1996	885	41	1852	735	20		01.135.843.0	1 unit
591	2196	885	46	2052	735	21		01.135.844.0	1 unit
591	1796	985	37	1652	835	20		01.133.600.0	1 unit
591	1996	985	41	1852	835	21		01.133.610.0	1 unit
591	2196	985	46	2052	835	22		01.133.620.0	1 unit
591	1796	1185	37	1652	1035	22		01.133.605.0	1 unit
591	1996	1185	41	1852	1035	23		01.133.615.0	1 unit
591	2196	1185	46	2052	1035	24		01.133.625.0	1 unit
691	1196	585	23	1052	435	15		01.135.799.3	1 unit
691	1796	585	37	1652	435	17		01.135.801.3	1 unit
691	1996	585	41	1852	435	18		01.135.802.3	1 unit
691	2196	585	46	2052	435	19		01.135.803.3	1 unit
691	1196	785	23	1052	635	17		01.135.823.3	1 unit
691	1796	785	37	1652	635	19		01.135.825.3	1 unit
691	1996	785	41	1852	635	20		01.135.826.3	1 unit
691	2196	785	46	2052	635	21		01.135.827.3	1 unit
691	1796	885	37	1652	735	19		01.133.630.0	1 unit
691	1996	885	41	1852	735	20		01.133.645.0	1 unit
691	2196	885	46	2052	735	22		01.133.660.0	1 unit
691	1796	985	37	1652	835	21		01.133.635.0	1 unit
691	1996	985	41	1852	835	22		01.133.650.0	1 unit
691	2196	985	46	2052	835	23		01.133.665.0	1 unit
691	1796	1185	37	1652	1035	23		01.133.640.0	1 unit
691	1996	1185	41	1852	1035	24		01.133.655.0	1 unit
691	2196	1185	46	2052	1035	25		01.133.670.0	1 unit
791	1200	585	23	1052	435	16		01.135.805.3	1 unit
791	1796	585	37	1652	435	18		01.135.807.3	1 unit
791	1996	585	41	1852	435	19		01.135.808.3	1 unit
791	2196	585	46	2052	435	20		01.135.809.3	1 unit

Continued on next page!

W	H	D	U	h	d	kg	Model	Order no.	UP
791	1196	785	23	1052	635	18		01.135.829.3	1 unit
791	1796	785	37	1652	635	20		01.135.831.3	1 unit
791	1996	785	41	1852	635	21		01.135.832.3	1 unit
791	2196	785	46	2052	635	22		01.135.833.3	1 unit
791	1796	885	37	1652	735	21		01.135.847.0	1 unit
791	1996	885	41	1852	735	22		01.135.848.0	1 unit
791	2196	885	46	2052	735	23		01.135.849.0	1 unit
791	1796	985	37	1652	835	20		01.133.675.0	1 unit
791	1996	985	41	1852	835	22		01.133.685.0	1 unit
791	2196	985	46	2052	835	24		01.133.695.0	1 unit
791	1796	1185	37	1652	1035	22		01.133.680.0	1 unit
791	1996	1185	41	1852	1035	24		01.133.690.0	1 unit
791	2196	1185	46	2052	1035	26		01.133.700.0	1 unit

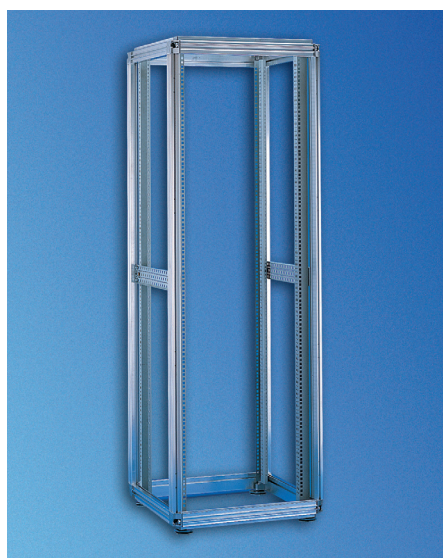

MIR20308

Knürr Miracel® 19" Basic Rack With 4 x 19" mounting hole extrusions (basis for rack widths 600 / 800)

- With fixed 19" installation on the front and rear
- Installation of slot-in runners and 19" shelves possible
- For components in acc. with IEC297-3
- **For installing:**
 - 19" components on the front and rear
 - Equipment with max. construction width of 450 mm
 - Installation accessories
- **Jumping space**
At the front: 73 mm
- **Load rating**
5000 N static
- **Tests**
 - Earthing in acc. with VDE 0100 T 540
 - Vibration test in acc. with MIL-STD 810 E
- **Material/finish**
 - Basic rack, extruded aluminum, polished
 - Corner piece, die-cast aluminum
 - Multifunctional braces and 19" sheet steel angular extrusions, zinc-passivated
- **Supply schedule**
 - 1 basic rack
 - 4 19" sheet steel angular extrusions with mounting holes
 - 2 multifunctional braces for cable clamping and universal mounting options
 - 4 leveling feet (0-25 mm)
- **How supplied**
- Assembled
- **Note Rack suites**
In a rack suite, per connection you require a set of suite connectors BN 01.130.935.7

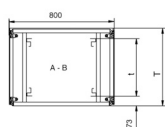
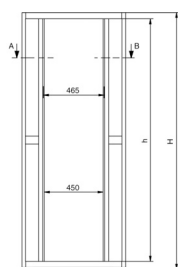
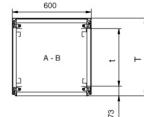
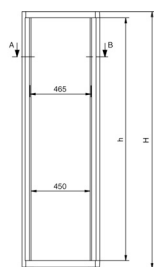

MIR00300

W	H	D	U	h	d	kg	Model	Order no.	UP
591	1196	585	23	1052	440	14		01.130.190.0	1 unit
591	1796	585	37	1652	440	16		01.130.193.0	1 unit
591	1996	585	41	1852	440	17		01.130.194.0	1 unit
591	2196	585	46	2052	440	18		01.130.195.0	1 unit
591	1196	785	23	1052	640	16		01.130.280.0	1 unit
591	1796	785	37	1652	640	18		01.130.283.0	1 unit
591	1996	785	41	1852	640	19		01.130.284.0	1 unit
591	2196	785	46	2052	640	20		01.130.285.0	1 unit
791	1196	585	23	1052	440	16		01.130.226.0	1 unit
791	1796	585	37	1652	440	18		01.130.229.0	1 unit
791	1996	585	41	1852	440	19		01.130.230.0	1 unit
791	2196	585	46	2052	440	20		01.130.231.0	1 unit
791	1196	785	23	1052	640	18		01.130.316.0	1 unit
791	1796	785	37	1652	640	20		01.130.319.0	1 unit
791	1996	785	41	1852	640	21		01.130.320.0	1 unit
791	2196	785	46	2052	640	22		01.130.321.0	1 unit



MIR20305

Knürr Miracel® 19" Distribution Rack with Swing Frame, NS 19.8 D Width 800, with front glass door, single

- With 19" swing frame for components in acc. with IEC 297-3
- Cable entry via plinth and top cover
- Cable entry on the top cover, can be completely removed at the rear, allowing top cover removal and replacement after cabling
- Dissipated heat discharge via raised fan roof
- Top cover prepared for upgrading with CoolBlast® range fan units. This enables flexible adjustments to customer requirements.
- Door opening angle, 180°

Load rating

800 N static in the swing frame
5000 N static in total

Protection rating

IP 40

Tests

- Earthing in acc. with VDE 0100 T 540
- Vibration test in acc. with MIL-STD 810 E
- IP test in acc. with DIN 40 050 / IEC 529

Material/finish

- Extruded aluminum
- Corner piece, die-cast aluminum
- Covers, zinc-passivated sheet steel, powder-coated texture
- Doors, sheet steel, powder-coated texture, glass infill, front door, single safety glass panel, 4 mm
- Swing frame, sheet steel, powder-coated, front board support, zinc-passivated
- Multifunctional braces and 19" swing frame, sheet steel, zinc-passivated

Color

Visible surface of covers, RAL 7035 light gray

Supply schedule

- 1 basic rack
- 1 19" swing frame with mounting holes for caged nuts M5
- 2 multifunctional braces for cable clamping and universal mounting options
- 1 raised top cover with cable entry (three-piece sliding plates, can also be opened completely), prepared for upgrading CoolBlast® fan units
- 1 front door, single, single safety glass panel, with handle and mounting for cylinder lock
- 1 rear panel with quick connectors
- 2 side panels with quick connectors
- 1 plinth for cable entry on the side and rear with leveling feet (0-25mm)
- 2 plinth panels for front and rear, with vent slots and fixing for filter mat
- 1 complete earthing test (VDE 0100)

How supplied

Assembled

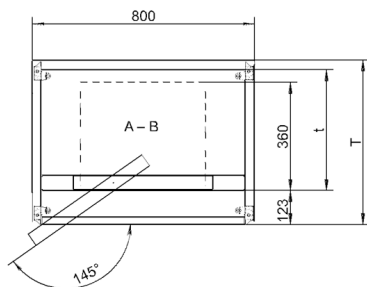

MIR00047

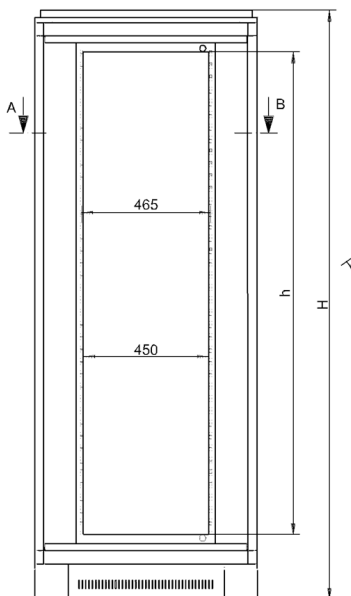

MIR00047

W	H	D	U	h	d	kg	Model	Order no.	UP
800	2120	600	38	1692.8	435	111	With side panels	01.135.274.1	1 unit
800	2320	600	42	1870.6	435	120	With side panels	01.135.275.1	1 unit
800	2120	800	38	1692.8	635	119	With side panels	01.135.292.1	1 unit
800	2320	800	42	1870.6	635	128	With side panels	01.135.293.1	1 unit

Dimensions in mm: W= Width, H= Height, D= Depth, h= installation height, d= useful depth, L= length, U= standard height unit, 1U=44.45 mm, UP= unit of packaging, kg= weight, = Express item

Conversion: 1 mm = 0.03937 inch, 1 kg = 2.2046 pound



MIR20309

Knürr Miracel® Without front door, width 600 mm

- With fixed 19" installation on the front and rear
- Installation of slot-in runners and 19" shelves possible
- For components in acc. with IEC297-3
- **For installing:**
 - 19" components on the front and rear
 - Equipment with max. construction width of 450 mm
 - Installation accessories
- **Jumpering space**
At the front: 73 mm
- **Load rating**
5000 N static
- **Tests**
 - Earthing in acc. with VDE 0100 T 540
 - Vibration test in acc. with MIL-STD 810 E
- **Material/finish**
 - Basic rack, extruded aluminum
 - Corner piece, die-cast aluminum
 - Covers and trim extrusions, zinc-passivated sheet steel, powder-coated texture
 - Multifunctional braces and 19" extrusions, sheet steel, zinc-passivated
- **Color**
 - Basic rack, polished
 - Visible surface of the covers, RAL 7035 light gray
 - Trim extrusions: RAL 5008 gray-blue
- **Supply schedule**
 - 1 basic rack
 - 4 19" sheet steel angular extrusions with mounting holes
 - 2 multifunctional braces for cable clamping and universal mounting options
 - 1 top cover, closed
 - 1 rear panel with quick connectors
 - 2 side panels with quick connectors
 - 2 horizontal trim extrusions, front
 - 2 vertical trim extrusions, front
 - 4 leveling feet (0-25 mm)
- **How supplied**
 - Assembled

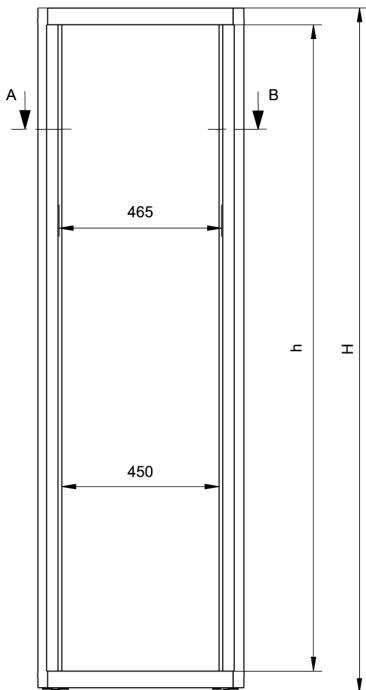

MIR00540

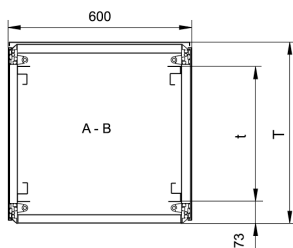

MIR00540

W	H	D	U	h	d	kg	Model	Order no.	UP
600	1200	600	23	1052	440	42		01.131.068.1	1 unit
600	1800	600	37	1652	440	57		01.131.071.1	1 unit
600	2000	600	41	1852	440	62		01.131.072.1	1 unit
600	2200	600	46	2052	440	66		01.131.073.1	1 unit
600	1200	800	23	1052	640	48		01.131.074.1	1 unit
600	1800	800	37	1652	640	63		01.131.077.1	1 unit
600	2000	800	41	1852	640	69		01.131.078.1	1 unit
600	2200	800	46	2052	640	75		01.131.079.1	1 unit

Dimensions in mm: W= Width
H = Height
D = Depth
h = installation height
d = useful depth
L = length

U = standard height unit
1 U = 44.45 mm
UP = unit of packaging
kg = weight

 = Express item

Conversion: 1 mm = 0.03937 inch
1 kg = 2.2046 pound



MIR20336

Knürr Miracel® IP 55 With glass door, single, width 600 mm

- With fixed 19" installation on the front and rear
- For components in acc. with IEC297-3
- Door opening angle, 180°
- **For installing:**
 - 19" components on the front and rear
 - Equipment with max. construction width of 450 mm
 - Installation accessories
- **Jumpering space**
At the front: 73 mm
- **Load rating**
5000 N static
- **Protection rating**
IP 55

Supply schedule

- 1 basic rack
- 4 19" sheet steel angular extrusions with mounting holes
- 2 multifunctional braces for cable clamping and universal mounting options
- 1 top cover, closed, IP 55
- 1 front door, single, single safety glass panel, with handle and mounting for cylinder lock, IP 55
- 1 rear panel with quick connectors, IP 55
- 2 side panels with quick connectors, IP 55
- 1 bottom cover, closed, IP 55
- 4 leveling feet (0-25 mm)

How supplied

- Assembled

Note Rack suites

To create a rack suite with "n" racks, you require:

- (n-1) racks without side panels
- 1 rack with side panels

In a rack suite, per connection you require a set of suite connectors BN 01.130.935.7

IP 55 sealing frame on request!

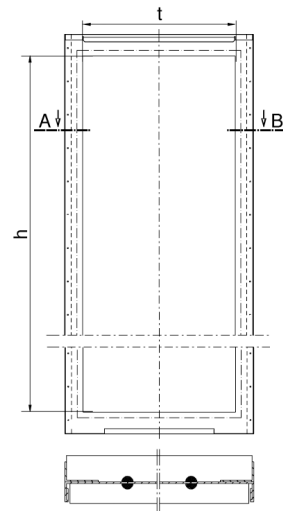

Sealing frame

MIR00304

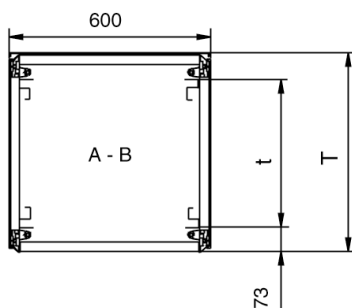
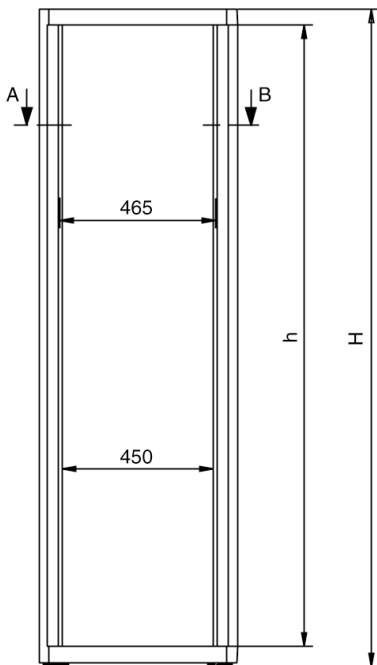

MIR00301

Dimensions in mm: W= Width
H = Height
D = Depth
h = installation height
d = useful depth
L = length

U = standard height unit
1 U = 44.45 mm
UP = unit of packaging
kg = weight

 = Express item

Conversion: 1 mm = 0.03937 inch 1 kg = 2.2046 pound

Tests

- Earthing in acc. with VDE 0100 T 540
- Vibration test in acc. with MIL-STD 810 E
- IP test in acc. with DIN 40 050 / IEC 529

Material/finish

- Basic rack, extruded aluminum, polished
- Corner piece, die-cast aluminum, polished
- Covers, zinc-passivated sheet steel, powder-coated texture
- Doors, sheet steel, powder-coated texture, glass infill, front door, single safety glass panel, 4 mm
- Multifunctional braces and 19" extrusions, sheet steel, zinc-passivated

Color

Visible surface of covers, RAL 7035 light gray

W	H	D	U	h	d	kg	Model	Order no.	UP
600	1200	600	23	1052	440	55		01.132.268.1	1 unit
600	1600	600	32	1452	440	69		01.132.270.1	1 unit
600	1800	600	37	1652	440	75		01.132.271.1	1 unit
600	2000	600	41	1852	440	80		01.132.272.1	1 unit
600	2200	600	46	2052	440	86		01.132.273.1	1 unit
600	1200	800	23	1052	640	65		01.132.274.1	1 unit
600	1600	800	32	1452	640	76		01.132.276.1	1 unit
600	1800	800	37	1652	640	83		01.132.277.1	1 unit
600	2000	800	41	1852	640	90		01.132.278.1	1 unit
600	2200	800	46	2052	640	96		01.132.279.1	1 unit



MIR00100

Miracel® Rack Connector Internal mounting

- For mechanical, stable connection of rack and frame suites

Material/finish
- Sheet steel, 2 mm, zinc passivated

Supply schedule
8 mounting brackets (for connecting 2 racks / frames)
Mounting material

How supplied
Flat-packed kit

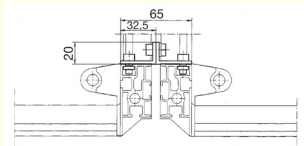

MIR00168

W	H	D	U	h	d	kg	Model	Order no.	UP
								01.130.935.7	1 unit

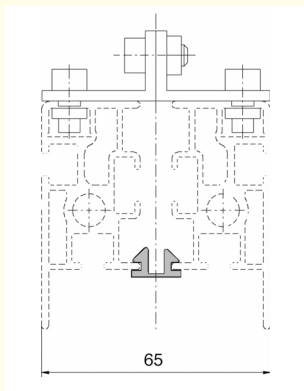

MIR00320

Miracel® Cover Extrusion for Rack Suites, IP20

Material
PVC extruder extrusion, black

Supply schedule
2 vertical lengths
2 depth lengths

W	H	D	U	h	d	kg	Model	Order no.	UP
1200		D 600	23					01.131.270.9	1 unit
1800		D 600	37					01.131.273.9	1 unit
2000		D 600	41					01.131.274.9	1 unit
2200		D 600	46					01.131.275.9	1 unit
1200		D 800	23					01.131.276.9	1 unit
1800		D 800	37					01.131.279.9	1 unit
2000		D 800	41					01.131.280.9	1 unit
2200		D 800	46					01.131.281.9	1 unit
1200		D 900	23					01.131.282.9	1 unit
1800		D 900	37					01.131.285.9	1 unit
2000		D 900	41					01.131.286.9	1 unit
2200		D 900	46					01.131.287.9	1 unit
2000		D 1000	41					01.127.760.9	1 unit
2200		D 1000	46					01.127.761.9	1 unit
2000		D 1200	41					01.127.762.9	1 unit
2200		D 1200	46					01.127.763.9	1 unit

Dimensions in mm: W= Width
H = Height
D = Depth
h = installation height
d = useful depth
L = length

U = standard height unit
1 U = 44.45 mm
UP = unit of packaging
kg = weight

= Express item

Conversion: 1 mm = 0.03937 inch 1 kg = 2.2046 pound

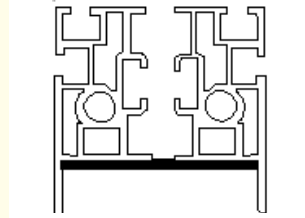

MIR20036

Miracel® Rack Connector External mounting

- For secure connection of several racks
- Front and rear external mounting

Material
- Sheet steel, 1 mm, zinc-passivated

Supply schedule
4 mounting straps
Mounting material

W	H	D	U	h	d	kg	Model	Order no.	UP
								01.127.114.9	1 unit

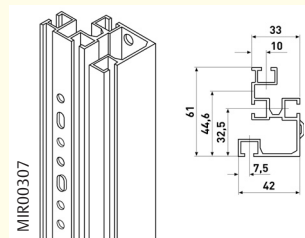

MIR00307

Miracel® 19" Vertical Extrusion, Aluminum With T-slot and increment slide

- For front and rear installation in the rack
- Spring nut, variable and adjustable in U increment (19")
- Please order suitable assembly kit for rack widths 700 / 800
- With W 600 screws and spring nuts

Material
Extruded aluminum, polished

Supply schedule
2 Vertical extrusions with increment slides

W	H	D	U	h	d	kg	Model	Order no.	UP
1200			23			1100		01.130.828.0	1 unit
1800			37			1700		01.130.834.0	1 unit
2000			41			1900		01.130.835.0	1 unit
2200			46			2100		01.130.836.0	1 unit

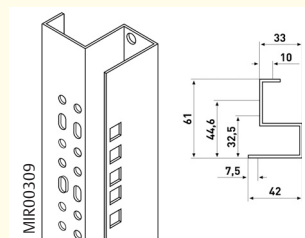

MIR00309

Miracel® 19" Vertical Extrusion, steel with mounting holes

- For front and rear installation in the rack
- Caged nut mountable in HU/U increments (19")
- Please order suitable assembly kit for rack widths 700 / 800
- With W 600 screws and spring nuts

Material
Sheet steel, 1.5 mm, zinc-passivated

Supply schedule
2 vertical extrusions with mounting holes

W	H	D	U	h	d	kg	Model	Order no.	UP
1200			23			1100		01.130.803.0	1 unit
1800			37			1700		01.130.809.0	1 unit
2000			41			1900		01.130.810.0	1 unit
2200			46			2100		01.130.811.0	1 unit

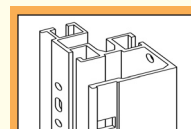

Note:

19" alu extrusions with mounting holes on request

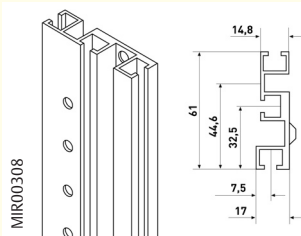

Type 1

Miracel® Vertical Extrusion, MEPS 20 modules

- For metric racks, 20 module
- Spring nut, stepless and adjustable in standard increment
- Please order suitable assembly kit for rack widths 700 / 800
- With W 600 screws and spring nuts

Material

- Type 1: Extruded aluminum, polished
- Type 2: Sheet steel, 1.5 mm, zinc-passivated

Supply schedule

2 vertical extrusions

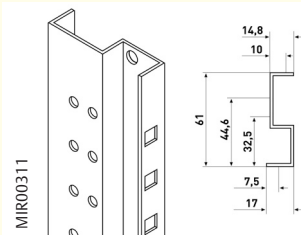

Type 2

W	H	D	U	h	d	kg	Model	Order no.	UP
1800			66	1700			Alu T-slot	01.130.847.0	1 unit
2000			74	1900			Alu T-slot	01.130.848.0	1 unit
2200			82	2100			Alu T-slot	01.130.849.0	1 unit
1800			66	1700			Steel mount. holes	01.130.822.0	1 unit
2000			74	1900			Steel mount. holes	01.130.823.0	1 unit
2200			82	2100			Steel mount. holes	01.130.824.0	1 unit

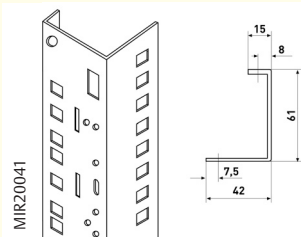

Miracel® 19" Server Extrusion, steel with mounting holes

- For mounting trade standard 19" servers
- Please order suitable assembly kit for rack widths 700 / 800
- Please order mounting adapter for Knürr standard components

Material

Sheet steel, 2 mm, zinc-passivated

Supply schedule

4 19" server extrusions

W	H	D	U	h	d	kg	Model	Order no.	UP
2000			41					01.127.214.0	1 unit
2200			46					01.127.215.0	1 unit

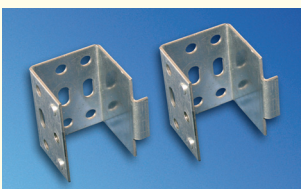

MIR20044

Miracel® Mounting Adapter for 19" Server Extrusion

- For mounting Knürr standard components (storage shelves, drawers, slot-in runners, keyboard runners, etc.) in 19" installation space

Material

Sheet steel, zinc-passivated

Supply schedule

4 adapters

W	H	D	U	h	d	kg	Model	Order no.	UP
			1					01.127.119.9	1 unit



MIR00510

Miracel® Assembly Kits for Extrusions

Supply schedule

- 4 node brackets (full installation)
- 2 node brackets (shortened installation)
- 2 Z brackets (shortened installation)
- Mounting material

W	H	D	U	h	d	kg	Model	Order no.	UP
700							Short inst.	01.131.219.7	1 unit
800							Short inst.	01.131.221.7	1 unit
700							Full inst.	01.131.220.7	1 unit
800							Full inst.	01.131.222.7	1 unit



LUF20337

Miracel® U Tape Measure

- For sticking on Miracel 19" extrusions
- Enables fast component positioning on the correct U position
- Standard length, 48 U; shorten as required

Supply schedule

1 tape measure

W	H	D	U	h	d	kg	Model	Order no.	UP
			48					01.128.400.9	1 unit

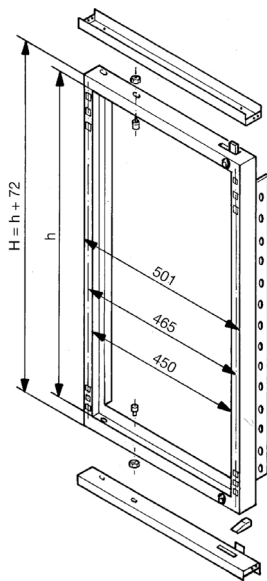

MIR00162

Miracel® Swing Frame 90° / 105° / 130°

- **Maximum installation weight**
80 kg
- **Also order assembly kit**
01.131.317.1
- **Swing frame earthing set**
01.110.610.9
- **Material**
Sheet steel, 2 mm
- **Finish**
Powder-coated texture, RAL 7035
light gray
- **Note**
The rack's nominal installation height is reduced by 3 U with the installation of a swing frame
- **Supply schedule**
1 frame
2 horizontal rails
1 square spanner
Mounting material
- **How supplied**
Flat-packed kit

W	H	D	U	h	d	kg	Model	Order no.	UP
800	2000	38	1692.8					01.117.079.1	1 unit

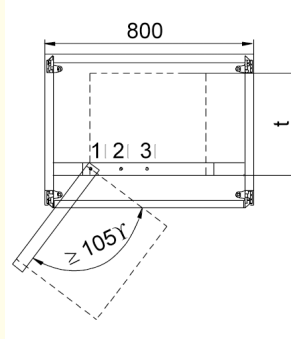

MIR00322

A

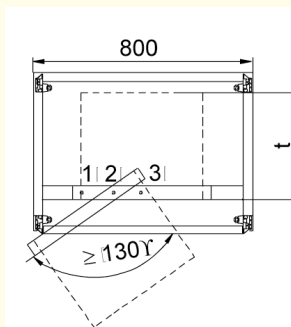

MIR00323

B

Useful depth according to rack type and pivot point

- A Center inst., pivot point 1
- B Center inst., pivot point 2
- C Center inst., pivot point 3

W [mm]	H [mm]	D [mm]
800		600
800		800

A	B	C	D
390	370	360	285
535	370	360	285

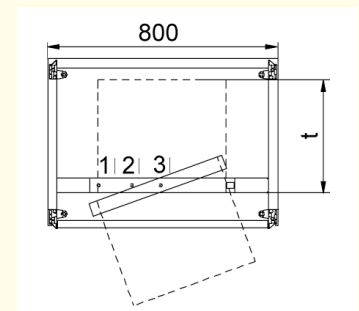

MIR00324

C



MIR00209

19° Swing Frame, 180°

- With swing frame use the rack must be screwed to the floor.
- Installation of the swing frame reduces the rack's nominal installation height by 2 U.
- With load rating > 80 kg installation weight, please also order additional assembly kit, side panel screwing!

- **19°-Drehrahmen 180°**
 - For mounting 19" components in acc. with IEC 297-3
 - Enables free accessibility to the second mounting level and to the installation components in the swing frame
 - Can be mounted in rack width 800 mm
 - Rack must be screwed to the floor

- **Material**
 - Frame, 2 mm sheet steel
 - Die-cast aluminum pivot bearing
- **Finish/color**
Frame and horizontal rail
Powder-coated texture, RAL 7035
light gray
Front panel support on the vertical post, zinc-passivated

- **Supply schedule**
1 19" swing frame, complete
1 horizontal mounting, below
1 horizontal mounting, above
1 square spanner
Mounting material

W	H	D	U	h	d	kg	Model	Order no.	UP
800	2000	39	1737					01.131.430.1	1 unit

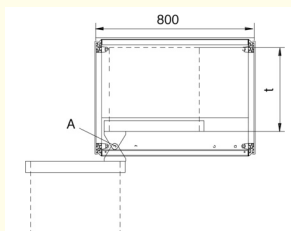

MIR00315

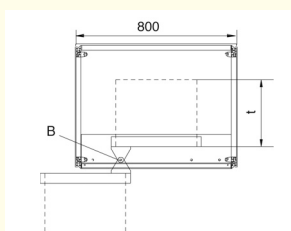

MIR00316

Useful depth according to rack type and pivot point

- A External inst., external pivot point
- B Center inst., pivot point 1

W [mm]	H [mm]	D [mm]
800		600/800

A	B
420	290

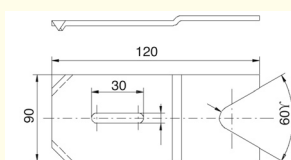

MIR00319

Assembly Kit Base fixing

- **Material**
Sheet steel, 3.0 mm
- **Finish**
Zinc-passivated
- **Supply schedule**
4 clamping plates

W	H	D	U	h	d	kg	Model	Order no.	UP
								01.130.934.7	1 unit



MIR20310

Miracel® Sheet Steel Door with perforation, single

- **Material**
Sheet steel, 1.0 mm
- **Finish/color**
Final digit of order number .1:
Powder-coated texture
RAL 7035 light gray
Final digit of order number .8:
Powder-coated texture
RAL 7021 dark gray
- **Supply schedule**
1 door
Mounting material
- **Volume flow**
A large surface perforation (83% free surface) enables optimum airflow through the rack



MIR20277

Miracel® Sheet Steel Door with perforation, double

- **Material**
Sheet steel, 1.0 mm
- **Finish/color**
Final digit of order number .1:
Powder-coated texture
RAL 7035 light gray
Final digit of order number .8:
Powder-coated texture
RAL 7021 dark gray
- **Supply schedule**
1 door
Mounting material
- **Volume flow**
A large surface perforation (83% free surface) enables optimum airflow through the rack

W	H	D	U	h	d	kg	Model	Order no.	UP
600	1200						Compl. door RAL 7035	01.147.400.1	1 unit
600	1200						Compl. door RAL 7021	01.147.400.8	1 unit
700	1200						Compl. door RAL 7035	01.147.401.1	1 unit
700	1200						Compl. door RAL 7021	01.147.401.8	1 unit
800	1200						Compl. door RAL 7035	01.147.402.1	1 unit
800	1200						Compl. door RAL 7021	01.147.402.8	1 unit
600	1800						Compl. door RAL 7035	01.147.412.1	1 unit
600	1800						Compl. door RAL 7021	01.147.412.8	1 unit
700	1800						Compl. door RAL 7035	01.147.413.1	1 unit
700	1800						Compl. door RAL 7021	01.147.413.8	1 unit
800	1800						Compl. door RAL 7035	01.147.414.1	1 unit
800	1800						Compl. door RAL 7021	01.147.414.8	1 unit
600	2000						Compl. door RAL 7035	01.147.416.1	1 unit
600	2000						Compl. door RAL 7021	01.147.416.8	1 unit
700	2000						Compl. door RAL 7035	01.147.417.1	1 unit
700	2000						Compl. door RAL 7021	01.147.417.8	1 unit
800	2000						Compl. door RAL 7035	01.147.418.1	1 unit
800	2000						Compl. door RAL 7021	01.147.418.8	1 unit
600	2200						Compl. door RAL 7035	01.147.420.1	1 unit
600	2200						Compl. door RAL 7021	01.147.420.8	1 unit
700	2200						Compl. door RAL 7035	01.147.421.1	1 unit
700	2200						Compl. door RAL 7021	01.147.421.8	1 unit
800	2200						Compl. door RAL 7035	01.147.422.1	1 unit
800	2200						Compl. door RAL 7021	01.147.422.8	1 unit

W	H	D	U	h	d	kg	Model	Order no.	UP
600	2000						Double door RAL 7035	01.128.260.1	1 unit
600	2000						Double door RAL 7021	01.128.260.8	1 unit
700	2000						Double door RAL 7035	01.128.261.1	1 unit
700	2000						Double door RAL 7021	01.128.261.8	1 unit
800	2000						Double door RAL 7035	01.128.262.1	1 unit
800	2000						Double door RAL 7021	01.128.262.8	1 unit
600	2200						Double door RAL 7035	01.128.263.1	1 unit
600	2200						Double door RAL 7021	01.128.263.8	1 unit
700	2200						Double door RAL 7035	01.128.264.1	1 unit
700	2200						Double door RAL 7021	01.128.264.8	1 unit
800	2200						Double door RAL 7035	01.128.265.1	1 unit
800	2200						Double door RAL 7021	01.128.265.8	1 unit

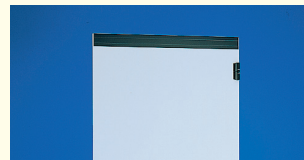

MIR00059

Miracel® Door Trim

- **Material**
Aluminum extrusion or sheet steel
- **Finish/color**
Powder-coated texture, RAL 9011
- **Supply schedule**
1 door trim (single doors)
2 door trims (double doors)
Mounting material
- **How supplied**
Flat-packed kit



MIR00060

W	H	D	Model	Order no.	UP
600			Door trim, double door*	01.133.200.9	1 set
700			Door trim, double door*	01.133.201.9	1 set
800			Door trim, double door*	01.133.202.9	1 set
600			Door trim	01.133.210.9	1 set
700			Door trim	01.133.211.9	1 set
800			Door trim	01.133.212.9	1 set

* Cannot be used for glass double doors

Dimensions in mm: W= Width
H = Height
D = Depth
h = installation height
d = useful depth
L = length
U = standard height unit
1 U = 44.45 mm
UP = unit of packaging
kg = weight
Express item

Conversion: 1 mm = 0.03937 inch
1 kg = 2.2046 pound



MIR20313



MIR20314

Knürr Miracel® Sheet Steel Door, single and double

- **Material**
Sheet steel, 1.0 mm
- **Finish/color**
Final digit of order number .1: Powder-coated texture
RAL 7035 light gray
Final digit of order number .8: Powder-coated texture
RAL 7021 dark gray
- **Protection rating**
With installation in the Miracel rack (depending on the other rack components), a maximum protection class of IP 55 can be achieved with IP 40 double doors.
- **Supply schedule**
1 sheet steel door
Mounting material
- **How supplied**
Preassembled

W	H	D	U	Model	Order no.	UP
700	2000	41		Double door, steel	01.131.841.1	1 unit
800	2000	41		Double door, steel	01.131.842.1	1 unit
600	2200	46		Double door, steel	01.131.845.1	1 unit
700	2200	46		Double door, steel	01.131.846.1	1 unit
800	2200	46		Double door, steel	01.131.847.1	1 unit



MIR20311

Knürr Miracel® Glass Door, single and double

- **Material**
Sheet steel 1.0 mm, single safety glass panel 4.0 mm, clear glass, double door 6.0 mm
- **Finish/color**
Final digit of order number .1: Powder-coated texture
RAL 7035 light gray
Final digit of order number .8: Powder-coated texture
RAL 7021 dark gray
- **Protection rating**
With installation in the Miracel rack (depending on the other rack components), a maximum protection class of IP 55 can be achieved with IP 20 double doors.
- **Supply schedule**
1 glass door
Mounting material
- **How supplied**
Preassembled



MIR20312

W	H	D	U	Model	Order no.	UP
600	1200	23		Compl. door RAL 7035	01.147.440.1	1 unit
600	1200	23		Compl. door RAL 7021	01.147.440.8	1 unit
700	1200	23		Compl. door RAL 7035	01.147.441.1	1 unit
700	1200	23		Compl. door RAL 7021	01.147.441.8	1 unit
800	1200	23		Compl. door RAL 7035	01.147.442.1	1 unit
800	1200	23		Compl. door RAL 7021	01.147.442.8	1 unit
600	1800	37		Compl. door RAL 7035	01.147.452.1	1 unit
600	1800	37		Compl. door RAL 7021	01.147.452.8	1 unit
700	1800	37		Compl. door RAL 7035	01.147.453.1	1 unit
700	1800	37		Compl. door RAL 7021	01.147.453.8	1 unit
800	1800	37		Compl. door RAL 7035	01.147.454.1	1 unit
800	1800	37		Compl. door RAL 7021	01.147.454.8	1 unit
600	2000	41		Compl. door RAL 7035	01.147.456.1	1 unit
600	2000	41		Compl. door RAL 7021	01.147.456.8	1 unit
700	2000	41		Compl. door RAL 7035	01.147.457.1	1 unit
700	2000	41		Compl. door RAL 7021	01.147.457.8	1 unit
800	2000	41		Compl. door RAL 7035	01.147.458.1	1 unit
800	2000	41		Compl. door RAL 7021	01.147.458.8	1 unit
600	2200	46		Compl. door RAL 7035	01.147.460.1	1 unit
600	2200	46		Compl. door RAL 7021	01.147.460.8	1 unit
700	2200	46		Compl. door RAL 7035	01.147.461.1	1 unit
700	2200	46		Compl. door RAL 7021	01.147.461.8	1 unit
800	2200	46		Compl. door RAL 7035	01.147.462.1	1 unit
800	2200	46		Compl. door RAL 7021	01.147.462.8	1 unit
600	1200	23		Double door, steel	01.131.820.1	1 unit
700	1200	23		Double door, steel	01.131.821.1	1 unit
800	1200	23		Double door, steel	01.131.822.1	1 unit
600	1800	37		Double door, steel	01.131.835.1	1 unit
700	1800	37		Double door, steel	01.131.836.1	1 unit
800	1800	37		Double door, steel	01.131.837.1	1 unit
600	2000	41		Double door, steel	01.131.840.1	1 unit

W	H	D	U	Model	Order no.	UP
600	1200	23		Compl. door, RAL 7035	01.147.480.1	1 unit
600	1200	23		Compl. door, RAL 7021	01.147.480.8	1 unit
700	1200	23		Compl. door, RAL 7035	01.147.481.1	1 unit
700	1200	23		Compl. door, RAL 7021	01.147.481.8	1 unit
800	1200	23		Compl. door, RAL 7035	01.147.482.1	1 unit
800	1200	23		Compl. door, RAL 7021	01.147.482.8	1 unit
600	1800	37		Compl. door, RAL 7035	01.147.492.1	1 unit
600	1800	37		Compl. door, RAL 7021	01.147.492.8	1 unit
700	1800	37		Compl. door, RAL 7035	01.147.493.1	1 unit
700	1800	37		Compl. door, RAL 7021	01.147.493.8	1 unit
800	1800	37		Compl. door, RAL 7035	01.147.494.1	1 unit
800	1800	37		Compl. door, RAL 7021	01.147.494.8	1 unit
600	2000	41		Compl. door, RAL 7035	01.147.496.1	1 unit
600	2000	41		Compl. door, RAL 7021	01.147.496.8	1 unit
700	2000	41		Compl. door, RAL 7035	01.147.497.1	1 unit
700	2000	41		Compl. door, RAL 7021	01.147.497.8	1 unit
800	2000	41		Compl. door, RAL 7035	01.147.498.1	1 unit
800	2000	41		Compl. door, RAL 7021	01.147.498.8	1 unit
600	2200	46		Compl. door, RAL 7035	01.147.500.1	1 unit
600	2200	46		Compl. door, RAL 7021	01.147.500.8	1 unit
700	2200	46		Compl. door, RAL 7035	01.147.501.1	1 unit
700	2200	46		Compl. door, RAL 7021	01.147.501.8	1 unit
800	2200	46		Compl. door, RAL 7035	01.147.502.1	1 unit
800	2200	46		Compl. door, RAL 7021	01.147.502.8	1 unit

Continued on next page!

W	H	D	U	Model	Order no.	UP
600	1200	23		Double door, glass	01.131.850.1	1 unit
700	1200	23		Double door, glass	01.131.851.1	1 unit
800	1200	23		Double door, glass	01.131.852.1	1 unit
600	1800	37		Double door, glass	01.131.862.1	1 unit
700	1800	37		Double door, glass	01.131.863.1	1 unit
800	1800	37		Double door, glass	01.131.864.1	1 unit
600	2000	41		Double door, glass	01.131.866.1	1 unit
700	2000	41		Double door, glass	01.131.867.1	1 unit
800	2000	41		Double door, glass	01.131.868.1	1 unit
600	2200	46		Double door, glass	01.131.870.1	1 unit
700	2200	46		Double door, glass	01.131.871.1	1 unit
800	2200	46		Double door, glass	01.131.872.1	1 unit

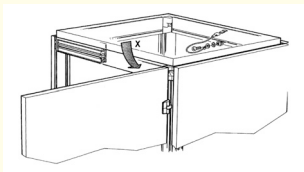

MIR00216

Door / Side Panel / Rear Panel Earthing Set

- For safe earthing of doors and covers

Supply schedule
1 earthingline
Mounting material

How supplied
Flat-packed kit

W	H	D	Model	Order no.	UP
			For doors	1.130.624.9	1 unit
			For side and rear panel	1.133.745.9	1 unit

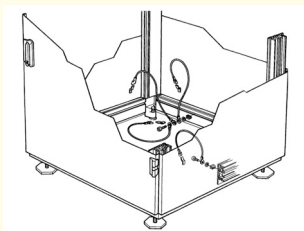

MIR00217

Rack Earthing Set

- For safe rack earthing
- Standardized protective conductor connection

Standards
IEC 950
VDE 0100

Supply schedule
5 earthinglines
Mounting material

How supplied
Flat-packed kit

W	H	D	Model	Order no.	UP
				01.130.529.9	1 unit

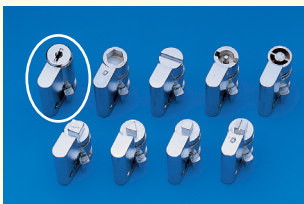

MIR00066

Door Locking Set

Supply schedule
1 lock set
2 keys (half-cylinder)

Note
Further cylinder locks on request!

W	H	D	U	h	d	kg	Model	Order no.	UP
								05.041.299.9	1 unit

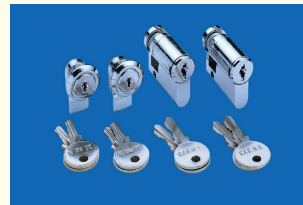

MIR00069

Complete Locking Set

Supply schedule
2 cylinders with 2 keys each
2 lockable fasteners for side panel with 2 keys each

W	H	D	U	h	d	kg	Model	Order no.	UP
								01.130.940.9	1 unit



MIR00068

Miracel® Locking Set (for side or rear panel)

- For installation in the side or rear panel
- For protection against unauthorized access
- Later installation also possible

Supply schedule
1 lockable fastener
2 keys

How supplied
Flat-packed kit

W	H	D	U	h	d	kg	Model	Order no.	UP
								01.130.938.9	1 unit

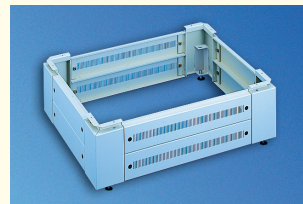

MIR00076

Miracel® Plinth, stationary, height 200 mm

- Stationary incl. leveling option
- Cable entry possible from all sides
- Panels front and rear with vent slots and installation option for filter mat

Load rating
3000 N static

Material
Sheet steel

Finish
Powder-coated texture, RAL 7035

Supply schedule
4 plinth corners with leveling feet
8 panels
Mounting material

How supplied
Flat-packed kit

W	H	D	U	h	d	kg	Model	Order no.	UP
600	200	600						01.130.958.1	1 unit
600	200	800						01.130.959.1	1 unit
600	200	900						01.130.960.1	1 unit
700	200	600						01.130.964.1	1 unit
700	200	800						01.130.965.1	1 unit
800	200	600						01.130.970.1	1 unit
800	200	800						01.130.971.1	1 unit

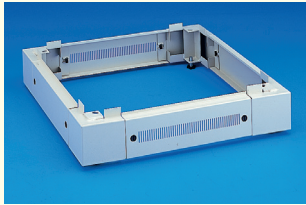

MIR00414

Miracel® Plinth Stationary, height 100 mm

- Stationary
- Cable entry possible from all sides
- Panels front and rear with vent slots and installation option for filter mat

Load rating
5000 N static

Material
Sheet steel

Finish
Powder-coated texture, RAL 7035

Supply schedule
4 plinth corners with leveling
2 plinth panels with slots
2 plinth panels closed on the side
Mounting material

How supplied
Flat-packed kit

W	H	D	U	h	d	kg	Model	Order no.	UP
600	100	600						01.130.538.1	1 unit
600	100	800						01.130.539.1	1 unit
600	100	900						01.130.540.1	1 unit
600	100	1000						01.127.650.1	1 unit
600	100	1200						01.133.710.1	1 unit
700	100	600						01.130.544.1	1 unit
700	100	800						01.130.545.1	1 unit
700	100	900						01.130.546.1	1 unit
700	100	1000						01.127.651.1	1 unit
700	100	1200						01.133.711.1	1 unit
800	100	600						01.130.550.1	1 unit
800	100	800						01.130.551.1	1 unit
800	100	900						01.130.552.1	1 unit
800	100	1000						01.127.652.1	1 unit
800	100	1200						01.133.712.1	1 unit



MIR20088

Miracel® Castors

- Can be mounted on the threaded eyelet of the basic rack
- Castor diameter, 75 mm
- Threaded bolt, M12
- Load capacity per castor: 100 kg

Supply schedule
4 swivel castors

How supplied
Flat-packed kit

W	H	D	U	h	d	kg	Model	Order no.	UP
	109.5							05.031.057.9	4 units

Dimensions in mm: W = Width
H = Height
D = Depth
h = installation height
d = useful depth
L = length

U = standard height unit
1 U = 44.45 mm
UP = unit of packaging
kg = weight

= Express item

Conversion: 1 mm = 0.03937 inch
1 kg = 2.2046 pound

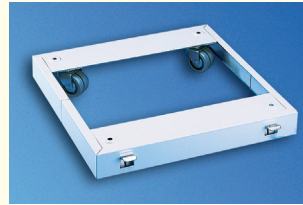

MIR00077

Miracel® Plinth Mobile, height 100 mm

- Mobile
- Cable entry possible on the rear
- With leveling feet for stationary model

Load rating
3000 N static

Material
Sheet steel, 2 mm

Finish
Powder-coated texture, RAL 7035

Supply schedule
1 plinth frame
2 fixed castors with snib
2 swivel castors
4 leveling feet
Mounting material

How supplied
Flat-packed kit

W	H	D	U	h	d	kg	Model	Order no.	UP
600	100	600						01.130.561.1	1 unit
600	100	800						01.130.562.1	1 unit
600	100	900						01.130.563.1	1 unit
600	100	1000						01.127.250.1	1 unit
600	100	1200						01.133.715.1	1 unit
700	100	600						01.130.565.1	1 unit
700	100	800						01.130.566.1	1 unit
700	100	1000						01.127.253.1	1 unit
700	100	1200						01.133.716.1	1 unit
800	100	600						01.130.569.1	1 unit
800	100	800						01.130.570.1	1 unit
800	100	900						01.130.571.1	1 unit
800	100	1000						01.127.254.1	1 unit
800	100	1200						01.133.717.1	1 unit



ELM00103a

Front Panel (pivots)

- For covering the side jumpering space on the front in Miracel racks, width 800
- Easy to open with jumpering work

Material/finish
Sheet steel, 1.0 mm, powder-coated texture

Color
RAL 7035 light gray

Supply schedule
2 front panels
Mounting material

How supplied
Flat-packed kit

W	H	D	U	h	d	kg	Model	Order no.	UP
		1003		23			For rack width 800	01.113.044.1	1 unit
		1003		23			For rack width 800	01.113.044.8	1 unit
		1803		41			For rack width 800	01.113.048.1	1 unit
		1803		41			For rack width 800	01.113.048.8	1 unit
		2002		46			For rack width 800	01.113.049.1	1 unit
		2002		46			For rack width 800	01.113.049.8	1 unit

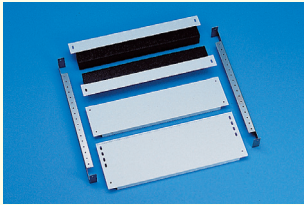

MIR00355

Miracel® Bottom Cover
For flexible cable entry with rubber sealing, IP 40

- For covering the rack underside
- With rubber sealing for flexible cable entry on the front and rear

Material/finish
Sheet steel, 1.5 mm, zinc-passivated
Sponge rubber, 50 mm x 50 mm

Supply schedule
1 cable entry
2 bottom covers
2 mounting brackets
Mounting material

How supplied
Flat-packed kit

W	H	D	U	h	d	kg	Model	Order no.	UP
600		600						01.130.732.0	1 unit
600		800						01.130.733.0	1 unit
600		900						01.130.734.0	1 unit
600		1000						01.127.670.0	1 unit
600		1200						01.133.740.0	1 unit
700		600						01.130.735.0	1 unit
700		800						01.130.736.0	1 unit
700		900						01.127.671.0	1 unit
700		1000						01.127.672.0	1 unit
700		1200						01.133.741.0	1 unit
800		600						01.130.738.0	1 unit
800		800						01.130.739.0	1 unit
800		900						01.130.740.0	1 unit
800		1000						01.127.673.0	1 unit
800		1200						01.133.742.0	1 unit



MIR00521

Miracel® Plinth Panel With brush strip

- For cable entry on the side, front and rear

Finish
Powder-coated texture, RAL 7035

Supply schedule
1 plinth panel with brush strip
Mounting material

How supplied
Flat-packed kit

W	H	D	U	h	d	kg	Model	Order no.	UP
600		600						01.130.744.1	1 unit
800		800						01.130.745.1	1 unit

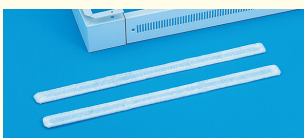

MIR00161

Miracel® Filter Mat for Plinth Panel
For installation in plinth panel on the front and rear

Supply schedule
2 filter mats

How supplied
Flat-packed kit

W	H	D	U	h	d	kg	Model	Order no.	UP
600								01.130.530.9	1 unit
700								01.130.531.9	1 unit
800								01.130.532.9	1 unit

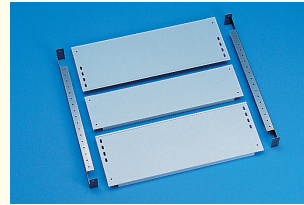

MIR00357

Miracel® Bottom Cover, 3-piece

- For covering the rack underside
- For flexible cable entry on the front and rear

Material/finish
Sheet steel, 1.5 mm, zinc-passivated

Supply schedule
3 bottom covers
2 mounting brackets
Mounting material

How supplied
Flat-packed kit

W	H	D	U	h	d	kg	Model	Order no.	UP
600		600						01.130.750.0	1 unit
600		800						01.130.751.0	1 unit
600		900						01.130.752.0	1 unit
600		1000						01.127.660.0	1 unit
600		1200						01.133.730.0	1 unit
700		600						01.130.753.0	1 unit
700		800						01.130.754.0	1 unit
700		900						01.130.755.0	1 unit
700		1000						01.127.662.0	1 unit
700		1200						01.133.731.0	1 unit
800		600						01.130.756.0	1 unit
800		800						01.130.757.0	1 unit
800		900						01.130.758.0	1 unit
800		1000						01.127.663.0	1 unit
800		1200						01.133.732.0	1 unit



MIR20331

Miracel® Quick Connectors
For side and rear panels

- Covers quickly fixed with 90° rotation of the connectors
- Easy to turn with wide flat-head screwdriver

Material/Color
Final digit of order number .1: Polyamide PA66
RAL 7035 light gray
Final digit of order number .9: Polyamide PA66
RAL 9011 dark gray

How supplied
Sets of 50 units

Model	Order no.	UP
For side panel RAL 7035	01.133.900.1	1 set
For side panel RAL 9011	01.133.900.9	1 set
For rear panel RAL 7035	01.133.910.1	1 set
For rear panel RAL 9011	01.133.910.9	1 set

Dimensions in mm: W= Width
H = Height
D = Depth
h = installation height
d = useful depth
L = length
U = standard height unit
1 U = 44.45 mm
UP = unit of packaging
kg = weight
📦 = Express item

Conversion: 1 mm = 0.03937 inch 1 kg = 2.2046 pound



MIR00064

Miracel® Side Panel

- **Protection rating**
With installation in the Miracel rack (depending on the other rack components), a maximum protection class of IP 55 can be achieved
- **Material**
Sheet steel, 1.0 mm
- **Finish/color**
Powder-coated texture, RAL 7035
- **Supply schedule**
1 Side panel
Mounting material
- **How supplied**
Flat-packed kit



MIR00064

Miracel® Rear Panel

- **Protection rating**
With installation in the Miracel rack (depending on the other rack components), a maximum protection class of IP 55 can be achieved
- **Material**
Sheet steel, 1.0 mm
- **Finish/color**
Powder-coated texture, RAL 7035
- **Supply schedule**
1 rear panel
Mounting material
- **How supplied**
Flat-packed kit

W	H	D	U	h	d	kg	Model	Order no.	UP
1200	600	23						01.130.643.1	1 unit
1200	800	23						01.130.649.1	1 unit
1200	900	23						01.130.655.1	1 unit
1800	600	37						01.130.646.1	1 unit
1800	800	37						01.130.652.1	1 unit
2000	600	41						01.130.647.1	1 unit
2000	800	41						01.130.653.1	1 unit
2000	900	41						01.130.659.1	1 unit
2000	1000	41						01.127.739.1	1 unit
2000	1200	41						01.128.874.1	1 unit
2200	600	46						01.130.648.1	1 unit
2200	800	46						01.130.654.1	1 unit
2200	900	46						01.130.660.1	1 unit
2200	1000	46						01.127.740.1	1 unit
2200	1200	46						01.128.875.1	1 unit

W	H	D	U	h	d	kg	Model	Order no.	UP
600	1200	23						01.130.662.1	1 unit
600	1800	37						01.130.665.1	1 unit
600	2000	41						01.130.666.1	1 unit
600	2200	46						01.130.667.1	1 unit
700	1200	23						01.130.668.1	1 unit
700	1800	37						01.130.671.1	1 unit
700	2000	41						01.130.672.1	1 unit
700	2200	46						01.130.673.1	1 unit
800	1200	23						01.130.674.1	1 unit
800	1800	37						01.130.677.1	1 unit
800	2000	41						01.130.678.1	1 unit
800	2200	46						01.130.679.1	1 unit

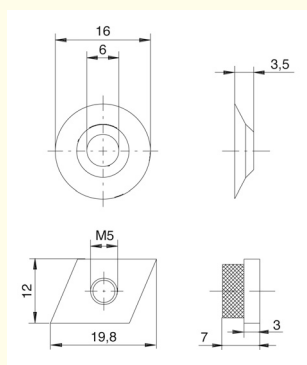

MIR00318

Miracel® Assembly Kit Side panel threaded connection

- For screwing the side panels instead of using quick connectors
- Provides additional rack strength
- **Material**
Countersunk washers and mounting nuts
Stainless steel
- **Supply schedule** (for 2 side panels)
16 countersunk washers
16 mounting nuts, M5
16 countersunk screws, M5 x 12
- **How supplied**
Flat-packed kit



MIR00068

Miracel® Locking Set (for side or rear panel)

- For installation in the side or rear panel
- For protection against unauthorized access
- Later installation also possible
- **Supply schedule**
1 lockable fastener
2 keys
- **How supplied**
Flat-packed kit

W	H	D	U	h	d	kg	Model	Order no.	UP
								01.130.938.9	1 unit

W	H	D	U	h	d	kg	Model	Order no.	UP
								01.130.937.9	1 unit

Dimensions in mm: W= Width
H = Height
D = Depth
h = installation height
d = useful depth
L = length

U = standard height unit
1 U = 44.45 mm
UP = unit of packaging
kg = weight

= Express item

Conversion: 1 mm = 0.03937 inch
1 kg = 2.2046 pound

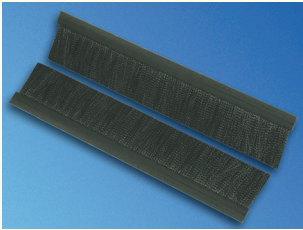

MIR20093

Miracel® Brush Strip

- Brush strip for all covers with cable entry
- For dust-protected and flexible cable entry
- Instead of mounting the sliding covers in the top cover

■ **Supply schedule**
2 brush strips

■ **How supplied**
Flat-packed kit

W	H	D	U	h	d	kg	Model	Order no.	UP
							For rack widths 700/800	01.130.999.9	1 unit
							For rack width 600	01.130.998.9	1 unit

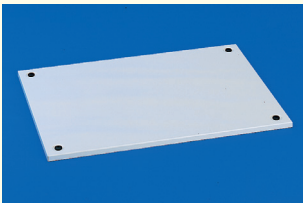

MIR00070

Miracel® Top Cover Closed, IP55

- Can be optionally used as top cover or bottom cover (combination with stationary plinth is not possible with use as bottom cover)

■ **Protection rating**
With installation in the Miracel rack (depending on the other rack components), a maximum protection class of IP 55 can be achieved.

■ **Finish**
Powder-coated texture, RAL 7035

■ **Supply schedule**
1 top cover, closed
Mounting material

■ **How supplied**
Flat-packed kit

W	H	D	U	h	d	kg	Model	Order no.	UP
600		600						01.130.690.1	1 unit
600		800						01.130.691.1	1 unit
600		900						01.130.692.1	1 unit
600		1000						01.127.700.1	1 unit
600		1200						01.133.760.1	1 unit
700		600						01.130.694.1	1 unit
700		800						01.130.695.1	1 unit
700		900						01.130.696.1	1 unit
700		1000						01.127.701.1	1 unit
700		1200						01.133.761.1	1 unit
800		600						01.130.691.1	1 unit
800		800						01.130.699.1	1 unit
800		900						01.130.700.1	1 unit
800		1000						01.127.702.1	1 unit
800		1200						01.133.762.1	1 unit



Note:
Knürr CoolBlast® Top-Mounting Fan
from page 1.109